



النصر للوكالات التجارية الفنية ذ.م.م.
ALNASR TECHNICAL TRADING AGENCIES L.L.C.

CATALOGUE

Alnasr Technical Trading Agencies L.L.C.



License#SCT-1202



License#7-1-0188



The background is a dark blue gradient. On the left side, there is a large, abstract geometric pattern composed of various shades of blue and grey triangles. A solid orange vertical bar is located on the far right edge. Orange geometric shapes, including a triangle and a square, are positioned at the bottom-left and top-right corners respectively.

*"**QUALITY** IS NEVER AN ACCIDENT; IT IS
ALWAYS THE RESULT OF HIGH **INTENTION**,
SINCERE **EFFORT**, INTELLIGENT **DIRECTION**
AND SKILLFUL **EXECUTION**."*



OUR PHILOSOPHY

VISION

To become one of the market leaders in the UAE manufacturing sector, providing locally patented and produced goods to the UAE and international markets, in line with the UAE government's directives for local manufacturing across all industries.

MISSION

To continuously expand our knowledge and expertise across the petroleum, maritime, railroad, construction, and lifting industries by strategically aligning ourselves with local and international partners in line with the UAE government's economic and industrial vision for 2030.

VALUES

Professionalism. Respect. Integrity. Diversity. Excellence.



INDEX

BEAM CLAMP	31
BRITX	69
CAMLOK PRODUCTS	56
CASTORS & WHEELS	70
CERTIFICATIONS	6
CHAIN HOIST	13
CHAIN HOIST DS SERIES	14
CHAIN SLING	40
CHAINS	17
CLEVIS C HOOK	27
CLEVIS GRAB HOOK	26
CLEVIS SELF LOCKING HOOK	21
CLEVIS SLING HOOK WITH LATCH	23
CONNECTING LINK	20
CONTAINER LIFTING LUGS	56
CORPORATE SOCIAL RESPONSIBILITY	81
EYE BOLTS	48
EYE GRAB HOOK	26
EYE SELF LOCKING HOOK	22
EYE SLING HOOK WITH LATCH	24
FABRICATION SERVICES	78
GEARED TROLLEYS	30
HAND WINCH	51
HARBOUR EQUIPMENT & MACHINERY	74
HEIGHT SAFETY EQUIPMENT	66
HORIZONTAL PLATE CLAMPS	32
HYDRAULIC EQUIPMENT	61
LEVER HOIST	16
LIFTING MAGNETS	49
LOAD MONITORING EQUIPMENT	70
LOW HEADROOM HOIST	15
MAN BASKET	63



INDEX

MASTER LINKS	18
MASTERLINK ASSEMBLY	19
OFFSHORE MOORING EQUIPMENT & SYSTEMS	72
OUR CLIENTS	84
PALLET TRUCKS	36
PLAIN TROLLEY	45
RATCHET LASHING BELT	37
RATCHET LOAD BINDER & G70 GRAB HOOK	35
ROUND SLING	39
SAFETY HARNESS AND LANYARD	64
SAFETY PIN BOW SHACKLE	10
SCREW PIN BOW SHACKLE	11
SCREW PIN DEE SHACKLE	12
SHORTENING CLUTCH	25
SITE TROLLEY	37
SKATES SETS	62
SNATCH BLOCKS	51
SORTING HOOKS	28
SPELTER SOCKETS	57
STEELWORK CLAMPING SYSTEMS	71
TESTING DEPARTMENT	76
TRIPOD	66
VEROPE	68
VERTICAL PLATE CLAMP	33
WEBBING SLING	38
WEDGE SOCKETS	59
WELD ON HOOK	27
WINCHES (ELECTRIC)	51
WIRE ROPE SLING	41
WIRE ROPE WINCH	51
YOUNG ADIPEC	82

DNV

Certificate No:
TAS000022B

TYPE APPROVAL CERTIFICATE

This is to certify:

That the Lifting set for offshore containers

with type designation(s)
Wire rope lifting sets for offshore containers

Issued to
ALNASR TECHNICAL TRADING AGENCIES L.L.C.
Abu Dhabi, United Arab Emirates

is found to comply with
DNV GL standard DNVGL-ST-E271 – 2.7-1 Offshore containers, January 2021
ISO 10855-2:2018 Offshore containers and associated liftings sets – Part 2: Design, manufacture and testing of lifting sets
IMO/MSC Circular 860
EN 13414-1 Wire rope slings

Application :
1, 2, 3, and 4 leg lifting sets, with forerunner where fitted, for lifting of:
- offshore container, with maximum gross mass 0 to 25000 kg

Issued at **Aberdeen** on **2021-04-20**

This Certificate is valid until **2026-04-13** .
DNV local unit: **Dubai**

Approval Engineer: **Elisabeth Legg**



for DNV
Signed: agreed by Word,
Brendan
Location: DNV Aberdeen,
UK
Date: 2021-04-20
DNV 13414-1:2017

Brendan Ward
Delivery Lead - Containers

This Certificate is subject to terms and conditions overleaf. Any significant change in design or construction may render this Certificate invalid. The validity date relates to the Type Approval Certificate and not to the approval of equipment/systems installed.

LEGAL DISCLAIMER: Unless otherwise stated in the applicable contract with the holder of this document, or following from mandatory law, the liability of DNV AS, its parent companies and their subsidiaries as well as their officers, directors and employees ("DNV") arising from or in connection with the services rendered for the purpose of the issuance of this document or reliance thereon, whether in contract or in tort (including negligence), shall be limited to direct losses and under any circumstance be limited to 300,000 USD.



Form code: TA 281

Revision: 2021-03

www.dnv.com

Page 1 of 3

DNV GL

Certificate No:
TAS00002HF

TYPE APPROVAL CERTIFICATE

This is to certify:

That the Offshore Container

with type designation(s)
P4M Kit Box

Issued to
Al Nasr Technical Trading Agencies
Abu Dhabi, United Arab Emirates

is found to comply with
DNV GL standard DNVGL-ST-E271 – 2.7-1 Offshore containers, August 2017
ISO 10855:2018 Offshore containers and associated liftings sets – Design, manufacture, testing, inspection and marking
IMO/MSC Circular 860

Application :
Max. gross mass (kg) 2800
Max. payload (kg) 2000
Max. sling leg angle 45
Enhancement factor 2.712

Issued at **Aberdeen** on **2020-05-22**
This Certificate is valid until **2025-05-21** .
DNV GL local unit: **Dubai**

Approval Engineer: **Elisabeth Legg**



for DNV GL

Satya Shyamala Kuppli
Delivery Lead - Containers

This Certificate is subject to terms and conditions overleaf. Any significant change in design or construction may render this Certificate invalid. The validity date relates to the Type Approval Certificate and not to the approval of equipment/systems installed.



Form code: TA 281

Revision: 2019-01

www.dnvgl.com

Page 1 of 2

© DNV GL 2014. DNV GL and the Horizon Graphic are trademarks of DNV GL AS.

DNV GL

Certificate No:
TAS00002H2

TYPE APPROVAL CERTIFICATE

This is to certify:

That the Offshore Container

with type designation(s)
Offshore Cargo Basket

Issued to
Al Nasr Technical Trading Agencies
Abu Dhabi, United Arab Emirates

is found to comply with
DNV GL standard DNVGL-ST-E271 – 2.7-1 Offshore containers, August 2017
ISO 10855:2018 Offshore containers and associated liftings sets – Design, manufacture, testing, inspection and marking
IMO/MSC Circular 860

Application :
Max. gross mass (kg) 4800
Max. payload (kg) 3500
Max. sling leg angle 45
Enhancement factor 2.000

Issued at **Aberdeen** on **2020-04-17**
This Certificate is valid until **2025-04-16** .
DNV GL local unit: **Dubai**

Approval Engineer: **Jack Moffatt**



for DNV GL

Elisabeth Legg
Principal Engineer

This Certificate is subject to terms and conditions overleaf. Any significant change in design or construction may render this Certificate invalid. The validity date relates to the Type Approval Certificate and not to the approval of equipment/systems installed.



Form code: TA 281

Revision: 2019-01

www.dnvgl.com

Page 1 of 2

© DNV GL 2014. DNV GL and the Horizon Graphic are trademarks of DNV GL AS.



DNV GL

Certificate No:
TAS00002KB

TYPE APPROVAL CERTIFICATE

This is to certify:
That the Offshore Container

with type designation(s)
Gun Box Frame

Issued to
**Al Nasr Technical Trading Agencies
Abu Dhabi, United Arab Emirates**

is found to comply with
**DNV GL standard DNVGL-ST-E271 – 2.7-1 Offshore containers, August 2017
ISO 10855:2018 Offshore containers and associated liftings sets – Design, manufacture,
testing, inspection and marking
IMO/MSC Circular 860**

Application :

Max. gross mass (kg)	10100
Max. payload (kg)	7500
Max. sling leg angle	45
Enhancement factor	1.496

Issued at **Aberdeen** on **2020-07-01**
This Certificate is valid until **2025-06-30** . for DNV GL
DNV GL local unit: **Dubai**

Approval Engineer: **Ross MacDonald**

Elisabeth Legg
Principal Engineer

This Certificate is subject to terms and conditions overleaf. Any significant change in design or construction may render this Certificate invalid.
The validity date relates to the Type Approval Certificate and not to the approval of equipment/systems installed.

LEGAL DISCLAIMER: Unless otherwise stated in the applicable contract with the holder of this document, or following from mandatory law, the liability of DNV GL AS, its parent companies and subsidiaries as well as their officers, directors and employees ("DNV GL") arising from or in connection with the services rendered for the purpose of the issuance of this document or reliance thereon, whether in contract or in tort (including negligence), shall be limited to direct losses and under any circumstance be limited to 300,000 USD.

Form code: TA 281

Revision: 2020-03

www.dnvgl.com

Page 1 of 2

© DNV GL 2014. DNV GL and the Horizon Graphic are trademarks of DNV GL AS.

DNV GL

Certificate No:
TAS00002TM

TYPE APPROVAL CERTIFICATE

This is to certify:
That the Offshore Container

with type designation(s)
5ft Cargo Basket

Issued to
**Al Nasr Technical Trading Agencies
Abu Dhabi, United Arab Emirates**

is found to comply with
**DNV GL standard DNVGL-ST-E271 – 2.7-1 Offshore containers, August 2017
ISO 10855:2018 Offshore containers and associated liftings sets – Design, manufacture,
testing, inspection and marking
IMO/MSC Circular 860**

Application :

Max. gross mass (kg)	2945
Max. payload (kg)	2000
Max. sling leg angle	45
Enhancement factor	2.626

Issued at **Aberdeen** on **2020-11-18**
This Certificate is valid until **2025-11-17** . for DNV GL
DNV GL local unit: **Abu Dhabi**

Approval Engineer: **Jack Moffatt**

Elisabeth Legg
Principal Engineer

This Certificate is subject to terms and conditions overleaf. Any significant change in design or construction may render this Certificate invalid.
The validity date relates to the Type Approval Certificate and not to the approval of equipment/systems installed.

LEGAL DISCLAIMER: Unless otherwise stated in the applicable contract with the holder of this document, or following from mandatory law, the liability of DNV GL AS, its parent companies and subsidiaries as well as their officers, directors and employees ("DNV GL") arising from or in connection with the services rendered for the purpose of the issuance of this document or reliance thereon, whether in contract or in tort (including negligence), shall be limited to direct losses and under any circumstance be limited to 300,000 USD.

Form code: TA 281

Revision: 2020-03

www.dnvgl.com

Page 1 of 2

© DNV GL 2014. DNV GL and the Horizon Graphic are trademarks of DNV GL AS.

DNV

Certificate No:
TAS00002ZD

TYPE APPROVAL CERTIFICATE

This is to certify:
That the Offshore Container

with type designation(s)
6ft Offshore Cargo Basket

Issued to
**Al Nasr Technical Trading Agencies
Abu Dhabi, United Arab Emirates**

is found to comply with
**DNV GL standard DNVGL-ST-E271 – 2.7-1 Offshore containers, January 2021
ISO 10855:2018 Offshore containers and associated liftings sets – Design, manufacture, testing, inspection
and marking
IMO/MSC Circular 860**

Application :

Max. gross mass (kg)	6292
Max. payload (kg)	5000
Max. sling leg angle	45
Enhancement factor	1.746

Issued at **Aberdeen** on **2021-04-09**
This Certificate is valid until **2026-04-08** . for DNV
DNV local unit: **Dubai**

Approval Engineer: **Yann Emeriau**

Elisabeth Legg
Principal Engineer

This Certificate is subject to terms and conditions overleaf. Any significant change in design or construction may render this Certificate invalid.
The validity date relates to the Type Approval Certificate and not to the approval of equipment/systems installed.

LEGAL DISCLAIMER: Unless otherwise stated in the applicable contract with the holder of this document, or following from mandatory law, the liability of DNV AS, its parent companies and their subsidiaries as well as their officers, directors and employees ("DNV") arising from or in connection with the services rendered for the purpose of the issuance of this document or reliance thereon, whether in contract or in tort (including negligence), shall be limited to direct losses and under any circumstance be limited to 300,000 USD.

Form code: TA 281

Revision: 2021-03

www.dnv.com

Page 1 of 2

CERTIFICATE OF CONFORMITY

ASTRON CERTIFICATION LLC

Certificate No: U-153

ALNASR TECHNICAL TRADING AGENCIES L.L.C.
 Scope:
 Trading of Lifting Equipment, Loose Lifting Tackles and Fall Protection Equipment. Manufacturing of Webbing Slings, Steel Wire Rope Slings and Chain Slings.

ALNASR TECHNICAL TRADING AGENCIES - EQUIPMENTS TECHNICAL INSPECTION L.L.C.
 Scope:
 Inspection and Testing of Lifting Equipment & Accessories.

CRESCENT OIL-FIELD SUPPLIES L.L.C.
 Scope:
 Supply of Drill Bits and Related Accessories.

Address:
 Plot No. 33 / M-43, Musaffah Industrial Area, P.O. Box 7355, Abu Dhabi, United Arab Emirates

has been found to conform to the
Quality Management System Standard

ISO 9001:2015

IAF / NACE Code : 17, 29 / 25, 46.71
 Original Date : 04-08-2005
 Current Date : 06-09-2021
 Expiry Date : 03-08-2023



 CHIEF OPERATIONS OFFICER





Registered Address: #1 & 3, Building # 13, Plot # 16, Musaffah M-44, P.O. Box: 4582, Abu Dhabi, UAE
 Lack of fulfillment of the conditions as set out in the certification agreement to this certificate may render invalid.
 To check the validity of the certificate please write to: msd@astrongroup.com

CERTIFICATE OF CONFORMITY

ASTRON CERTIFICATION LLC

Certificate No: N-140

ALNASR TECHNICAL TRADING AGENCIES L.L.C.
 Scope:
 Trading of Lifting Equipment, Loose Lifting Tackles and Fall Protection Equipment. Manufacturing of Webbing Slings, Steel Wire Rope Slings and Chain Slings.

ALNASR TECHNICAL TRADING AGENCIES - EQUIPMENTS TECHNICAL INSPECTION L.L.C.
 Scope:
 Inspection and Testing of Lifting Equipment & Accessories.

CRESCENT OIL-FIELD SUPPLIES L.L.C.
 Scope:
 Supply of Drill Bits and Related Accessories.

Address:
 Plot No. 33 / M-43, Musaffah Industrial Area, P.O. Box 7355, Abu Dhabi, United Arab Emirates

has been found to conform to the
Environmental Management System Standard

ISO 14001:2015

IAF / NACE Code : 17, 29 / 25, 46.71
 Original Date : 04-08-2005
 Current Date : 06-09-2021
 Expiry Date : 03-08-2023



 CHIEF OPERATIONS OFFICER





Registered Address: #1 & 3, Building # 13, Plot # 16, Musaffah M-44, P.O. Box: 4582, Abu Dhabi, UAE
 Lack of fulfillment of the conditions as set out in the certification agreement to this certificate may render invalid.
 To check the validity of the certificate please write to: msd@astrongroup.com

CERTIFICATE OF CONFORMITY

ASTRON CERTIFICATION LLC

Certificate No: A-142

ALNASR TECHNICAL TRADING AGENCIES L.L.C.
 Scope:
 Trading of Lifting Equipment, Loose Lifting Tackles and Fall Protection Equipment. Manufacturing of Webbing Slings, Steel Wire Rope Slings and Chain Slings.

ALNASR TECHNICAL TRADING AGENCIES - EQUIPMENTS TECHNICAL INSPECTION L.L.C.
 Scope:
 Inspection and Testing of Lifting Equipment & Accessories.

CRESCENT OIL-FIELD SUPPLIES L.L.C.
 Scope:
 Supply of Drill Bits and Related Accessories.

Address:
 Plot No. 33 / M-43, Musaffah Industrial Area, P.O. Box 7355, Abu Dhabi, United Arab Emirates

has been found to conform to the
Occupational Health & Safety Management System Standard

ISO 45001:2018

IAF / NACE Code : 17, 29 / 25, 46.71
 Original Date : 04-08-2005
 Current Date : 06-09-2021
 Expiry Date : 03-08-2023



 CHIEF OPERATIONS OFFICER



Registered Address: #1 & 3, Building # 13, Plot # 16, Musaffah M-44, P.O. Box: 4582, Abu Dhabi, UAE
 Lack of fulfillment of the conditions as set out in the certification agreement to this certificate may render invalid.
 To check the validity of the certificate please write to: msd@astrongroup.com

ACCREDITATION CERTIFICATE

IB-75

Emirates International Accreditation Centre

has accredited

**ALNASR TECHNICAL TRADING AGENCIES – EQUIPMENTS
 TECHNICAL INSPECTION L.L.C.**

Plot No. 33/ M-43, Musaffah Industrial Area, P.O. Box: 7355
 Abu Dhabi-United Arab Emirates

In accordance with the requirements of
ISO/IEC 17020:2012

Conformity Assessment-Requirements for the operation of various type of bodies
 performing inspection
 to undertake the inspection in the attached accreditation scope

This Accreditation is invalid without the attached accreditation scope and shall remain in force
 within the validity period printed below, subject to continuing compliance with the requirements of
 the accreditation criteria.

Validity: 16/08/2021 to 16/09/2024
 Initial Accreditation Date: 17/09/2015





 CHIEF EXECUTIVE OFFICER
 APPROVAL





هيئة الإمارات للمواصفات والمقاييس
Emirates Authority For Standardization & Metrology



شهادة تسجيل Certificate Of Registration

Certification Number	R-IB-19-00260	رقم الشهادة
Name of the Applicant	Alnasr Technical Trading Agencies- Equipments Technical Inspection النصر للتوكيلات التجارية الفنية - قسم فحص الفني للمعدات	إسم الجهة
Initial Issue Date	08-May-2019	تاريخ الإصدار لأول مرة
Expiry Date	15-May-2022	تاريخ الإنهاء
Trade Licence No	CN-1067400	رقم الرخصة التجارية
Address	(16th Street, Mussaffah- M43 - Abu Dhabi, United Arab Emirates)	العنوان
Registration Scopes	Inspection Bodies	مجالات التسجيل

This certificate is valid for the CAB having the same trade license and address mentioned above. It's applicable for renewal, updates within compliance of the technical requirements, the related standards and the registered scopes are subjected to continuous compliance with the requirements of the authority.



تعتبر هذه الشهادة صالحة للرخصة التجارية والعنوان المذكور أعلاه كما بالإمكان إعادة تحديث وإعادة الإصدار حتى تاريخ الانتهاء المدون أعلاه. شريطة استمرار الجهة المذكورة أعلاه في تطبيق المواصفات والمتطلبات الفنية المرتبطة بها وتتجمل الجهة مسؤولة الشهادات الصادرة عنها وتخضع مجالات التسجيل المذكورة في شهادة التسجيل المرفقة لعمليات متابعة لاحقة من قبل الهيئة.

This is an electronic certificate and does not require stamp and signature. Visit ENAS website www.enas.gov.ae to verify this certification. Any alteration or modification on this certificate will affect its validity.

600-565554

ص.ب. 2166 أبو ظبي، الإمارات العربية المتحدة
P.O.BOX 2166, Abu Dhabi - United Arab Emirates

هذه الشهادة صدرت إلكترونياً ولا تحتاج لغم أو توقيع.
للتأكد من صحة هذه الشهادة يرجى زيارة موقعنا على الانترنت www.enas.gov.ae أي كنشط أو تغير في هذه الشهادة يلغها.

Initial Registration Date: 08/May/2019

تاريخ منح التسجيل لأول مرة: 08/May/2019



Lifting Equipment Engineers Association Certificate of Membership 2021

We hereby certify that
**Alnasr Technical Trading Agencies
United Arab Emirates**
having been audited in accordance with the Association's technical audit procedure specified in document reference LEER 042 has been admitted as a

Full Member

for the location(s) and scope of work detailed in the schedule bearing the same number as this certificate

Certificate Number
701



For and on behalf of LEER

[Signature]
Chairman

[Signature]
Chief Executive

Date of Certificate - 1st January 2021

Date of expiry of Certificate - 31st December 2021

This certificate is the property of the Association and shall be returned on demand. It is not issued under, in pursuance or by virtue of any statutory or Government sanction but by the authority of the Association only. It is valid only in the country listed above.



By Royal Charter

Certificate of BSI Membership

This is to certify that

Alnasr Technical Trading Agencies
Membership Number

47205796

is a BSI Subscribing Member

Start date: 1 December 2020 End date: 30 November 2021

For and on behalf of BSI:

[Signature]
Dr Scott Steadman CBE FREng, Director of Standards, BSI

The British Standards Institution is incorporated by Royal Charter and the rules relating to Subscribing Members are contained in its bye-laws. This certificate remains the property of the Institution and is only valid for the period ending on the 'End date' specified above.

BSI Group, 389 Chiswick High Road, London, W4 4AL, UK. Tel: +44 345 086 9001
bsimembers.com



...making excellence a habit.™

SAFETY PIN BOW SHACKLE



- Standard BS EN13889
- Grade 6 high tensile steel body and pin
- Safety Factor 6:1
- Tested & Certified
- High Quality
- Fully Embossed for Easy Identification
- Galvanised Finish

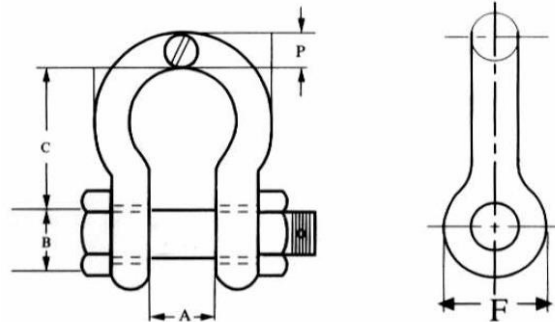

NOMINAL SIZE IN	WLL TON	WEIGHT KG/PC	DIMENSIONS (mm)				
			A	B	C	P	F
3/8"	1	0.2	16.7	11.1	36.5	9.5	24.6
1/2"	2	0.36	20.6	15.9	47.6	12.7	30.2
5/8"	3.25	0.76	27.0	19.1	60.3	17.2	39.7
3/4"	4.75	1.23	31.8	22.2	71.5	19.1	47.6
7/8"	6.5	1.79	36.5	25.4	84.1	22.2	54.0
1"	8.5	2.78	42.9	28.6	95.3	25.4	60.3
1-1/8"	9.5	3.75	46.0	31.8	104.8	28.6	66.7
1-1/4"	12	5.31	51.6	34.9	119.1	31.8	76.2
1-3/8"	13.5	6.98	57.2	38.1	131.8	34.9	84.1
1-1/2"	17	9.43	60.3	41.3	146.1	38.1	92.1
1-3/4"	25	15.38	73.0	50.8	177.8	44.5	104.8
2"	35	23.7	82.6	54.0	196.9	50.8	127.0
2-1/2"	55	44.57	104.8	60.3	266.7	63.5	152.4

SCREW PIN BOW SHACKLE



- Standard BS EN13889
- Grade 6 high tensile steel body and pin
- Safety Factor 6:1
- Tested & Certified
- High Quality
- Fully Embossed for Easy Identification
- Galvanised Finish

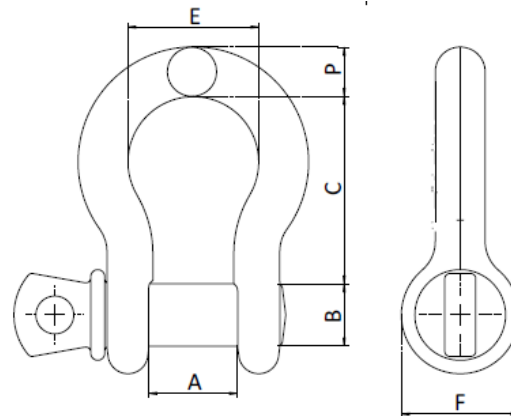

NOMINAL SIZE IN	WLL TON	WEIGHT KG/PC	DIMENSIONS (mm)					
			A	B	C	P	E	F
3/8"	1	0.14	16.7	11.1	36.5	9.5	26.2	24.6
7/16"	1.5	0.17	18.3	12.7	42.9	11.1	29.4	27.0
1/2"	2	0.29	20.6	15.9	47.6	12.7	33.3	30.2
5/8"	3.25	0.63	27.0	19.1	60.3	15.9	42.9	39.7
3/4"	4.75	1.02	31.8	22.2	71.4	19.1	50.8	47.6
7/8"	6.5	1.53	36.5	25.4	84.1	22.2	57.9	54.0
1"	8.5	2.41	42.9	28.6	95.3	25.4	68.3	60.3
1-1/8"	9.5	3.09	46.0	31.8	108.0	28.6	73.8	66.7
1-1/4"	12	4.31	51.6	34.9	119.1	31.8	82.6	76.2
1-3/8"	13.5	6.01	57.2	38.1	131.8	34.9	88.9	84.1
1-1/2"	17	8.03	60.3	41.3	146.1	38.1	98.4	92.1
1-3/4"	25	13.78	73.0	50.8	177.8	44.5	127.0	109.5
2"	35	20.41	82.6	57.2	196.9	50.8	146.1	127.0
2-1/2"	55	38.90	104.8	60.3	266.7	63.5	184.2	152.4

SCREW PIN DEE SHACKLES



- Standard BS EN13889
- Grade 6 high tensile steel body and pin
- Safety Factor 6:1
- Tested & Certified
- High Quality
- Fully Embossed for Easy Identification
- Galvanised Finish

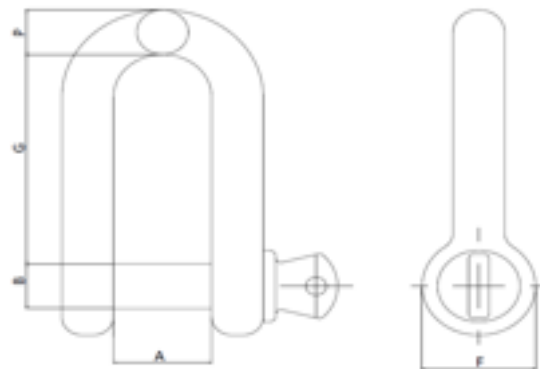

NOMINAL SIZE IN	WLL TON	WEIGHT KG/PC	DIMENSIONS (mm)				
			A	B	G	P	F
3/8"	1	0.11	16.7	11.1	31.8	9.5	24.6
7/16"	1.5	0.17	18.3	12.7	36.5	11.1	27.0
1/2"	2	0.23	20.6	15.9	41.3	12.7	30.2
5/8"	3.35	0.55	27.0	19.1	50.8	15.9	39.7
3/4"	4.75	0.91	31.8	22.2	60.3	19.1	47.6
7/8"	6.5	1.49	36.5	25.4	71.4	22.2	54.0
1"	8.5	2.15	42.9	28.6	81.0	25.4	60.3
1-1/8"	9.5	2.86	46.0	31.8	90.5	28.6	66.7
1-1/4"	12	4.08	51.6	34.9	100.0	31.8	76.2
1-3/8"	13.5	5.44	57.2	38.1	111.1	34.9	84.1
1-1/2"	17	7.33	60.3	41.3	122.2	38.1	92.1
1-3/4"	25	13.59	73.0	50.8	146.1	44.5	104.8
2"	35	19.6	82.6	57.2	171.5	50.8	127.0
2-1/2"	55	33.2	104.8	69.9	203.2	63.5	152.4

CHAIN HOIST



- Lightweight design
- Double pawl brake system
- High quality bearings for long life and easy operation
- High quality G8 load chain & hand chain
- Heavy duty safety catches
- Standard BS EN 13157

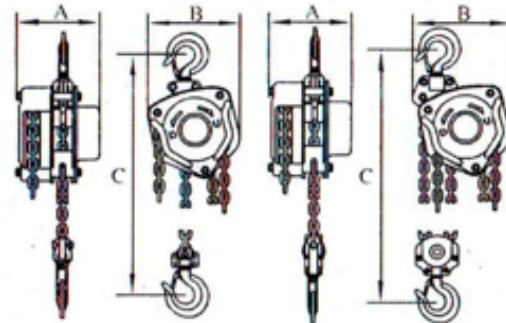

Model		ATTACB0.5T3	ATTACB1T3	ATTACB2T3	ATTACB3T3	ATTACB5T3
Capacity		0.5t	1t	2t	3t	5t
Standard lift (m)		3	3	3	3	3
Running test load (kN)		6.3	12.5	25	37.5	75
Effort required to lift max. load (N)		231	309	360	340	414
Number of falls		1	1	1	2	2
Load chain dia (mm)		6	6	8	8	10
Dimensions (mm)	A	131	140	161	161	186
	B	127	158	187	199	253
	C	270	317	414	465	636
Net weight (Kg)		10	12	22	32	46
Extra Weight per meter (Kg)		1.7	1.7	2.3	3.7	5.6

CHAIN BLOCK – DS Series

Available in

- Explosion Proof Type
- Corrossion Proof Type
- Stainless Steel Type



Specifications

MODEL	CAPACITY (TON)	STD. CHAIN LENGTH		CHAIN SPEC.		CHAIN WEIGHT / LIFT 1m (kg)		OPERATION LOAD (kg)	NO. OF LOAD CHAIN FALLS	STD. NET WEIGHT (kg)
		LOAD CHAIN	HAND CHAIN	LOAD CHAIN	HAND CHAIN	LOAD CHAIN	HAND CHAIN			
DS-005	0.5	2.5	2.0	06.3 x P19.1	05.0 x P23.3	0.86	0.92	18.0	1	10.5
DS-010	1.0	2.5	2.0	06.3 x P19.1	05.0 x P23.3	0.86	0.92	33.0	1	10.5
DS-015	1.5	2.5	2.0	07.1 x P20.2	05.0 x P23.3	1.11	0.92	33.0	1	13.0
DS-020	2.0	3.0	2.5	07.9 x P23.0	05.0 x P23.3	1.36	0.92	34.0	1	20.0

Dimensions

Model	CAPACITY (TON)	DIMENSIONS (mm)						
		H(Min)	L1	L2	W1	W2	T	D
DS-005	0.5	330.0	65.0	85.0	79.0	61.0	25.0	038.0
DS-010	1.0	330.0	65.0	85.0	79.0	61.0	25.0	038.0
DS-015	1.5	360.0	70.5	92.5	84.8	64.7	27.0	041.0
DS-020	2.0	400.0	82.5	110.5	90.3	72.0	32.0	046.0

LOWHEADROOM HOIST - EXPLOSION PROOF TYPE

Manual Low headroom hoist for Curved beam type is a model which curved beam trolley and chain block is combined. Minimum distance ("H" value) from beam to hook is very low; therefore it is optimized for application in environment with extremely low ceiling height equipped with curved beam track.

In addition, the minimum curve radius of the beam has been reduced to the lowest possible value.

DSLPG model is combined to a push trolley while DSLG is combined to a geared trolley

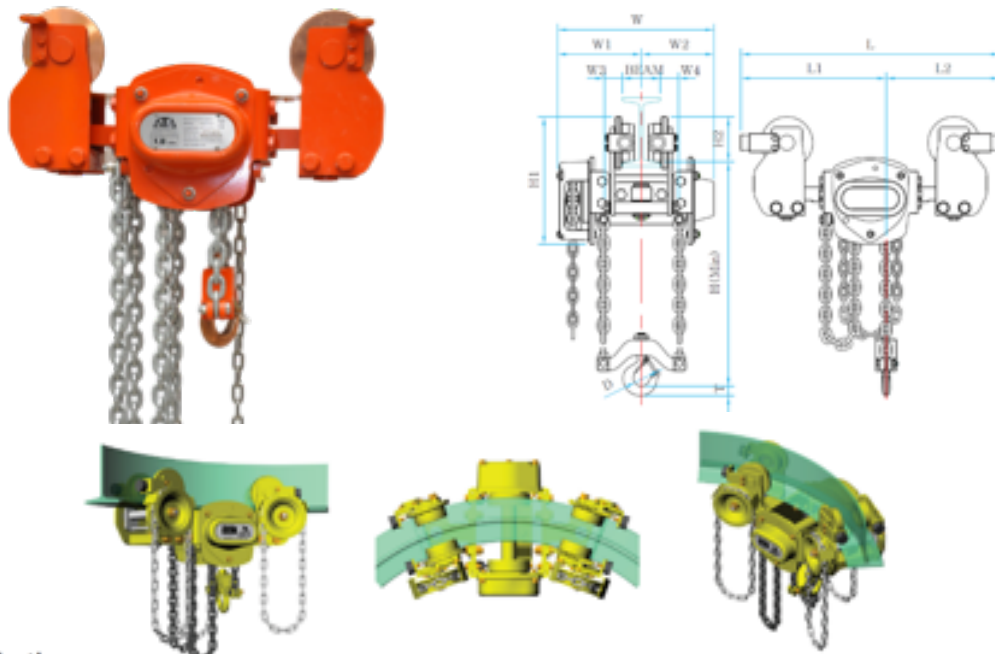

Specifications

MODEL	CAPACITY (TON)	I-BEAM FLANGE WIDTH (mm)	MIN. CURVE RADIUS (mm)	STD. CHAIN LENGTH				CHAIN SPEC.		CHAIN WEIGHT / LIFT 1m (kg)		OPERATION LOAD (kg)	NO. OF LOAD CHAIN FALLS	STD. NET WEIGHT (kg)
				LOAD CHAIN (C/B)	HAND CHAIN (C/B)	HAND CHAIN (T/R)	HAND CHAIN (P/D)	LOAD CHAIN	HAND CHAIN	LOAD CHAIN	HAND CHAIN			
DSLPG-010	1.0	75 - 125	500	2.5	2.0	-	-	ø7.1 x P20.2	ø5.0 x P23.3	2.22	0.92	44.0	2	38.0
DSLPG-020	2.0	100 - 150	700	3.0	2.5	-	-	ø7.1 x P20.2	ø5.0 x P23.3	4.44	0.92	44.0	4	62.0
DSLPG-010	1.0	75 - 125	500	2.5	2.0	2.0	-	ø7.1 x P20.2	ø5.0 x P23.3	2.22	0.92	44.0	2	42.0
DSLPG-020	2.0	100 - 150	700	3.0	2.5	2.5	-	ø7.1 x P20.2	ø5.0 x P23.3	4.44	0.92	44.0	4	67.0
DSLPG-040	4.0	100 - 150	1000	3.0	2.5	2.5	-	ø7.1 x P20.2	ø5.0 x P23.3	4.44	0.92	38.8	4	98.0
DSLPG-060	6.0	125 - 175	1200	3.0	2.5	2.5	-	ø9.5 x P28.6	ø5.0 x P23.3	7.76	0.92	52.5	4	161.0

Dimensions

MODEL	DIMENSIONS (mm)													
	H (Min)	H1	H2	L	L1	L2	BEAM SIZE	W	W1	W2	W3	W4	D	T
DSLPG-010	170.0	251.0	88.5	511.0	286.5	224.5	75 - 125	309.0	165.5	143.5	36.0	36.0	ø31.8	18.5
DSLPG-020	175.0	266.0	93.5	601.0	332.5	268.5	100 - 150	342.0	182.0	160.0	39.0	39.0	ø38.1	25.5
DSLPG-010	170.0	251.0	88.5	518.0	286.5	231.5	75 - 125	309.0	165.5	143.5	38.5	77.5	ø31.8	18.5
DSLPG-020	175.0	266.0	93.5	609.0	332.5	276.5	100 - 150	342.0	182.0	160.0	41.5	80.5	ø38.1	25.5
DSLPG-040	220.0	326.0	124.0	712.0	399.5	312.5	100 - 150	390.0	202.0	188.0	45.5	85.0	ø50.5	36.7
DSLPG-060	254.0	395.5	128.0	842.5	486.5	356.0	125 - 175	443.0	153.5	214.5	58.0	98.5	ø63.5	46.2

LEVER HOIST



- Lightweight & compact Ease of use due to optimal gear ratio
- Easy pull through of load chain (not when loaded)
- Rubberised handle for comfort
- All Lever hoists fitted with 1.5 metres of load chain (longer available)
- Quality high strength load chain, 360° swivel latch hooks
- Lifting chain length can be altered to your requirements.
- Heavy duty safety catch
- Standard BS EN 13157

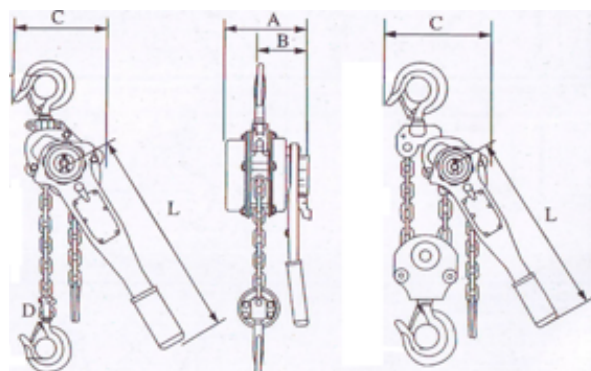

Model	ATTALH0.75T1.5	ATTALH1.5T1.5	ATTALH3T1.5	ATTALH6T1.5
Capacity	0.75t	1.5t	3t	6t
Standard Lift (m)	1.5	1.5	1.5	1.5
Test load (t)	1	2	4	8
Minimum distance between hooks (mm)	350	400	500	700
Pull on lever to lift full load (N)	160	230	380	410
Number of Falls	1	1	1	2
Load Chain Dia (mm)	6	8	10	10
Dimensions (mm)	A	148	172	200
	B	90	98	115
	C	136	160	180
D	30	35	40	50
L	280	410	410	410
Net weight (Kg)	7	11	21	31
Extra Weight per meter (Kg)	0.8	1.4	2.2	4.4

GRADE 80 CHAIN

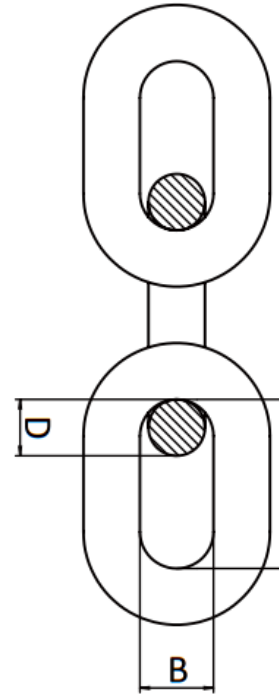

Size (Ø)	Inside Length (A)	Inside Width (B)	WLL	Breaking & Proof Force		Weight
mm	mm	mm	t	MPF (kN)	BF (kN)	Kg/m
7	21	9.1	1.5	38.5	61.6	1.1
8	24	10.4	2	50.3	80.4	1.4
10	30	13	3.15	78.5	126	2.2
13	39	16.9	5.3	133	212	3.8
16	48	20.8	8	201	322	5.7
20	60	26	12.5	314	503	9
22	66	28.6	15	380	608	10.9
26	78	33.8	21.2	531	849	15.2
32	96	41.6	31.5	804	1290	23

GRADE 80 MASTER LINK

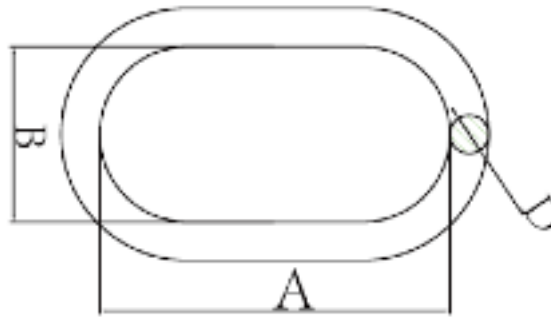

Model	Size	Weight	WLL	A	B	D
		Kg/Pc	t	mm	mm	mm
A20B7	20*90*170mm	1.3	5.8T	170	90	20
A22ML	22*100*180mm	1.6	8T	180	100	22
A28ML	28*140*270mm	3.8	10.5T	270	140	28
A32ML	32*145*275mm	5.1	16T	275	145	32
A36ML	36*140*270mm	6.5	23T	270	140	36
A40B7	40*160*300mm	8.9	25T	300	160	40
A45B6	45*170*320mm	12.2	34T	320	170	45
A50ML	50*190*350mm	16.6	45T	350	190	50
A60ML	60*220*410mm	29.2	60T	410	220	60

GRADE 80 MASTER LINK ASSEMBLY

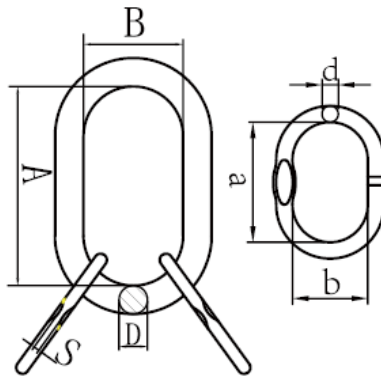

Model	Size	Weight	WLL	A	B	D	a	b	d
		Kg/Pc	t						
A20QA	20*90*160mm	2.5	5.8	160	90	20	120	70	16
A22QA	22*100*180mm	3.2	6.7	180	100	22	150	70	18
A28QA	28*145*275mm	6.8	11.2	275	145	28	160	90	22
A32QA	32*145*275mm	9.3	17	275	145	32	180	100	25
A36QA	36*140*270mm	11.9	23	270	140	36	185	90	28
A40QA	40*155*280mm	16.4	29	280	155	40	200	110	32
A45QA	45*175*320mm	23.5	36.5	320	175	45	225	125	36
A50QA	50*195*350mm	32.3	45.2	350	195	50	260	130	40
A60QA	60*220*410mm	63.9	60	410	220	60	350	195	50

GRADE 80 CONNECTING LINK

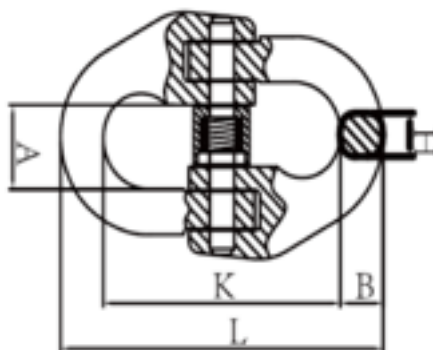

Size mm	Weight Kg/Pc	WLL t	BL t	A mm	B mm	L mm	K mm	H mm
7/8	0.2	2	8	18	9.5	79.5	60.5	8.5
10	0.3	3.15	12.6	25	12	90.5	68	11.5
13	0.7	5.3	21.2	29	15	117	87	15
16	1.1	8	32	34.5	19.8	148	108.4	19.8
20	1.8	12.5	50	41	24	169.5	121.5	24
22	3.2	15	60	48	26	193.5	141.5	26
26	4.5	21.2	84.8	57.5	31	220	158	30
32	8.2	31.5	126	67	38	281	205	37

GRADE 80 CLEVIS SELF LOCKING HOOK

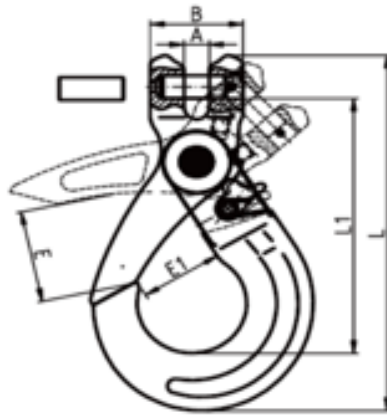

Size mm	Weight Kg/Pc	WLL	BL	Dimensions (mm)					
		mm	Kg/Pc	A	B	E	E1	L1	L
7/8	0.8	2	8	9.5	38.5	40	35.8	119	162
10	1.38	3.15	12.6	12.5	46	50	45	142	195
13	2.81	5.3	21.2	15	59	60	52.5	179	249
16	6	8	32	18.5	77	65	63.3	225	310
20	7.25	12.5	50	25	77	80	86	238	335
22	12.8	15	60	25	97.5	83	76	277	392
26	21.8	21.2	84.8	30	118	106	96	321	450
32	49.6	31.5	126	35	150	140	135	416	589.6

GRADE 80 EYE SELF LOCKING HOOK

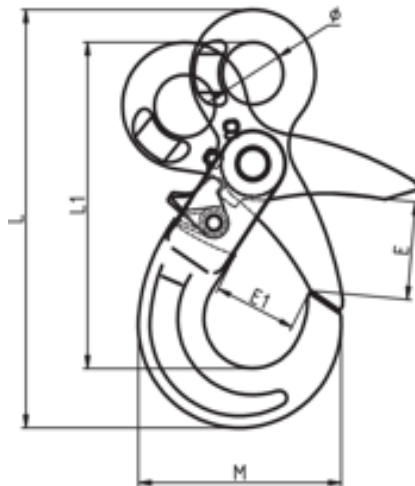

Size mm	Weight Kg/Pc	WLL	BL	Dimensions (mm)				
		T	t	Ø	E	E1	L1	L
7/8	0.9	2	8	25	40	35	136	175
10	1.6	3.15	12.6	34.5	50	45	168	214
13	3	5.3	21.2	40	60	52.5	207	268
16	5.9	8	32	50	65	63.3	254	332
20	7	12.5	50	64.5	80	86	274.5	332
22	12.3	15	60	70	83	76	319	415
26	20	21.2	84.8	80	106	96	362	472
32	44	31.5	126	105	140	133	470	614

GRADE 80 CLEVIS SLING HOOK WITH LATCH

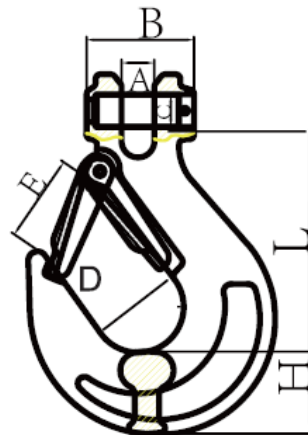

Size mm	Weight Kg/Pc	WLL	BL	Dimensions (mm)					
		t	t	A	B	E	D	H	L
7/8	0.48	2	8	9.5	37	29	37	32.5	85.5
10	0.95	3.15	12.6	13	49	39	46	35	104
13	1.8	5.3	21.2	16.5	56.5	47	56	42.5	128
16	3.4	8	32	21.5	70.5	55	60	54	150
20	6	12.5	50	24	77	61	79	58	180
22	10.4	15	60	27	91	72	101	62	213
26	14.5	21.1	84.8	30	117	85	115	75	250
32	27	31.5	126	35	150	106	140	88	317

GRADE 80 EYE SLING HOOK WITH LATCH

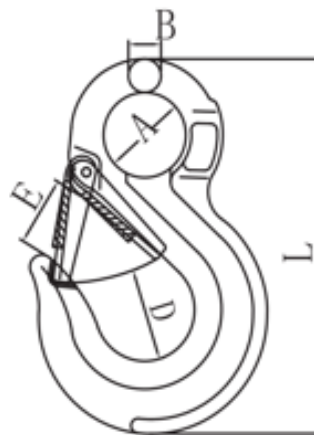

Size mm	Weight Kg/Pc	WLL	BL	Dimensions (mm)				
		t	t	B	E	D	A	L
7/8	0.4	2	8	11	30	26	25	133
10	0.9	3.15	12.6	15	34	39	38	167
13	1.7	5.3	21.2	19	39	54	43	213
16	3.2	8	32	23	46	64	50	255
20	5.8	12.5	50	24	48	80.4	62	305
22	8.5	15	60	32	71	100	62	348
26	13	21.2	84.8	35	81	108	64	394
32	17	31.5	126	37	102	112	88	480

GRADE 80 SHORTENING CLUTCH

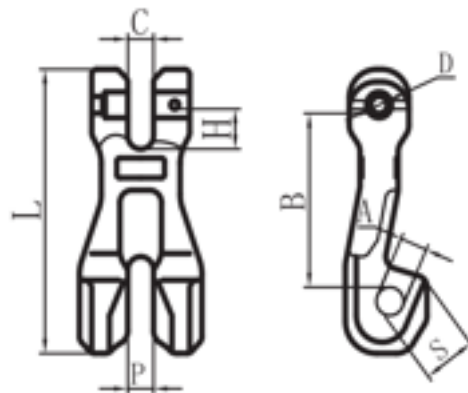

Size mm	Weight Kg/Pc	WLL	BL	Dimensions (mm)							
		t	t	P	C	A	B	H	S	L	D
7/8	0.4	2	8	9.5	9.5	10.5	61.7	14	17	101	9.2
10	1.0	3.15	12.6	13	13	12.4	92	18.4	28	137	13.2
13	2.0	5.3	21.2	16.5	16.5	16	115	22.7	34.5	177	16.2
16	3.3	8	32	21	21	19.5	143	28.5	40	220	20
20	6.2	12.5	50	23.5	23.5	23	152	33.6	46	238	24.3
22	8.5	15	60	25.5	25.5	26	195	39	57.5	295	28.1

GRADE 80 CLEVIS GRAB HOOK

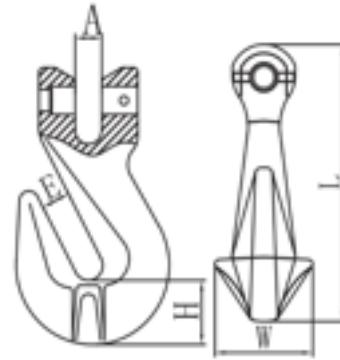

Size mm	Weight Kg/Pc	WLL	BL	Dimensions (mm)					
		t	t	E	A	H	W	L	
7/8	0.3	2	8	11	9.5	18.5	33.5	89	
10	0.7	3.15	12.6	13	12.5	29	46	126	
13	1.6	5.3	21.2	16.5	15	42.7	57.5	163.5	
16	2.8	8	32	19	18.5	45	74	183.5	
20	5.0	12.5	50	24	23	56	74	219	
22	6.3	15	60	27	27	68.5	90	254	
26	14.5	21.2	84.8	30	30	77	102	309	

GRADE 80 EYE GRAB HOOK



Size mm	Weight Kg/Pc	WLL	BL	Dimensions (mm)					
		t	t	E	D	H	R	L	
7/8	0.2	2	8	10.8	18	20	61.5	91.2	
10	0.7	3.15	12.6	13	20	29	80	122	
13	1.4	5.3	21.2	16.5	26	42.8	99.7	158	
16	2.2	8	32	20	30.5	47.7	104	169	
20	4.6	12.5	50	25	37.5	56	140	219	
22	8.2	15	60	28	44	68	165	259	
26	9.8	21.2	84.8	30	44	77	188.8	298	
32	19.4	31.5	126	38	57	95	228	361	

GRADE 80 WELD ON HOOK

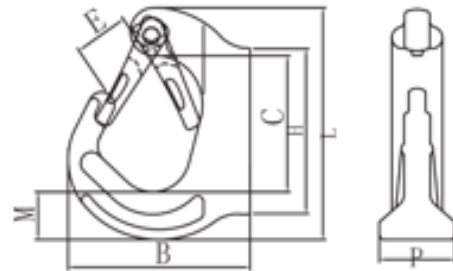

Size	Weight Kg/Pc	WLL	BL	Dimensions (mm)						
		t	t	B	C	E	H	M	P	L
2T	0.8	2	10	92	67	30	81	23.3	34	114
5T	2.5	5	15	133	94	35	159	44	43.5	171
8T	3.3	8	40	136.5	94	33.31	159	44	51	177

GRADE 80 CLEVIS C HOOK

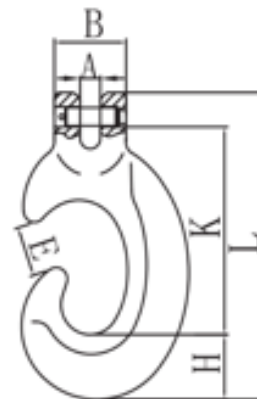

Size mm	Weight Kg/Pc	WLL	BL	Dimensions (mm)						
		t	t	A	E	B	H	K	L	
7/8	0.57	2	8	9.5	20	35	28	90	136	
10	1.4	3.15	12.6	13	29.5	46	39.5	127	189	
13	3	5.3	21.2	16.5	39.5	59	52	166.5	246	
16	5.42	8	32	18.5	46.5	72	59	206	298	

SORTING HOOKS

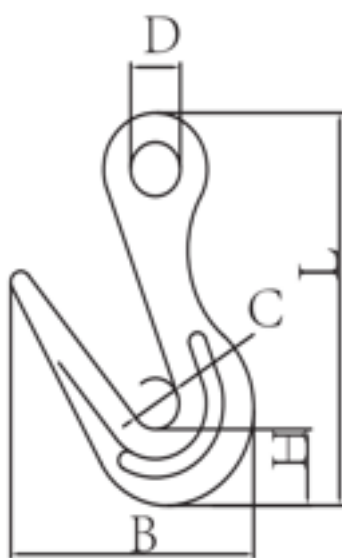

Size	Weight Kg/Pc	WLL	BL	Dimensions (mm)				
		t	t	D	B	C	L	H
2t	3.09	2	8	25	97.5	83	76	392

PLAIN TROLLEY



- Adjustable beam trolley
- Easy attachment to most RSJ/Beams
- Simple rotation of bar to adjust width
- High grade sealed ball bearing wheels
- Anti-drop plates
- Low headroom
- Hoists fit directly on to the trolley
- Fits beam widths from 50mm-305mm

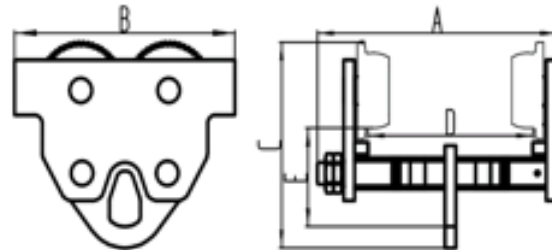

Size	Dimensions (mm)				
	A	B	C	D	E
GCT-II / 0.5T	215	226	181	50-152	98
GCT-II / 1T	280	226	188	64-203	103
GCT-II / 1.5T	290	265	217	74-203	114
GCT-II / 2T	290	265	217	88-203	114
GCT-II / 3T	300	297	249	100-203	122
GCT-II / 5T	410	323	273	114-305	132
GCT-II / 10T	435	400	337	124-305	161

GEARED TROLLIES



- Easy Attachment to beams
- Simple rotation of bar to adjust width
- High grade sealed ball bearing Wheels
- Anti-drop bars
- Low headroom
- Movement controlled by hand chain
- Length of chain to suit your needs

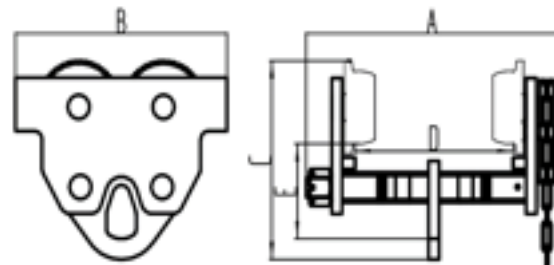

Size	Dimensions (mm)				
	A	B	C	D	E
GCL-II / 0.5T	255	226	181	50-152	98
GCL-II / 1T	320	226	188	64-203	103
GCL-II / 1.5T	330	265	217	74-203	114
GCL-II / 2T	330	265	217	88-203	114
GCL-II / 3T	341	297	249	100-203	122
GCL-II / 5T	453	323	273	114-305	132
GCL-II / 10T	475	394	337	124-305	161

BEAM CLAMP



- Adjustable Beam Clamp
- Pivoting eye to attached a hoist
- Easily adjustable to fit most beams by turning central threaded adjusting bars

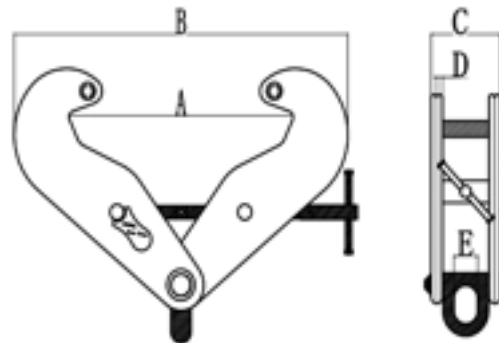

Model	SWL kg	Beam Width (mm)	A		B		C mm	D mm	E mm
			Min mm	Max mm	Min mm	Max mm			
TBE / 1T	1000	70-245	70	245	177	350	75	4	28
TBE / 2T	2000	70-245	70	245	177	350	83	6	28
TBE / 3T	3000	70-355	70	355	230	451	114	8	42
TBE / 5T	5000	70-355	70	355	230	451	122	10	42

HORIZONTAL PLATE CLAMPS



- Industrial Quality
- Quick & Easy Installation
- Locking Mechanism

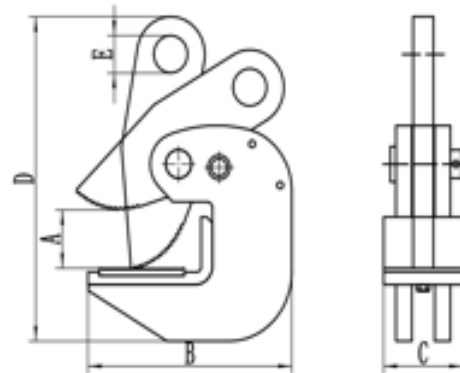

Model		PDB / 3T	PDB / 5T	PDB / 8T
Capacity Load(kg)		3000	5000	8000
Jaw Opening(mm)		0-30	0-45	0-60
DIMENSIONS (mm)	A	30	45	60
	B	180	185	320
	C	70	75	90
	D	260	275	405
	E	30	30	40

VERTICAL PLATE CLAMP



- Hardened steel jaws
- Locking mechanism
- Hinged attachment

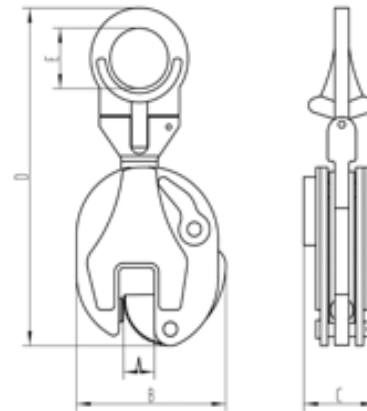

Model		QC 1T	QC 2T	QC 3T	QC 5T
Capacity Load(kg)		1000	3000	4000	5000
Jaw Opening(mm)		0-20	0-25	0-30	0-52
DIMENSIONS (mm)	A	20	25	30	52
	B	136	168	212	235
	C	66	81	91	100
	D	284	368	430	465
	E	47	65	70	70

ATA SAFETY HARNESS & LANYARD



- Model: TE5109
- Full Body Safety Harness
- Easy to fit
- Double adjustable (leg & chest)
- Extremely light & comfortable
- Standard EN 361:2002

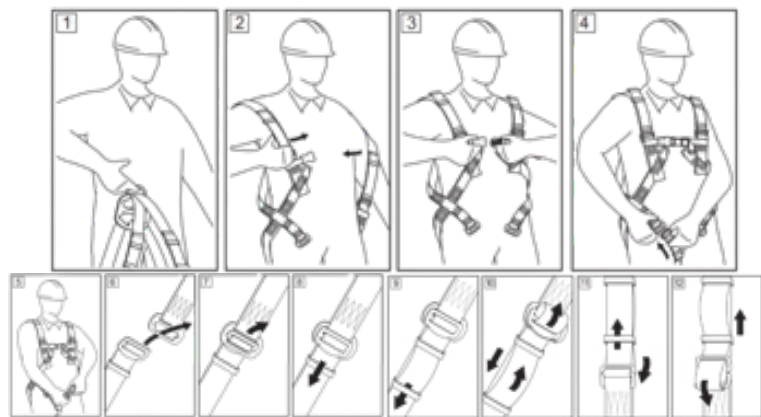

- Model: TE6106
- Webbing Y Lanyards
- Extremely light & comfortable
- Complete with Shock absorber
- Complete with Scaffolding hooks
- Standard EN 355:2002

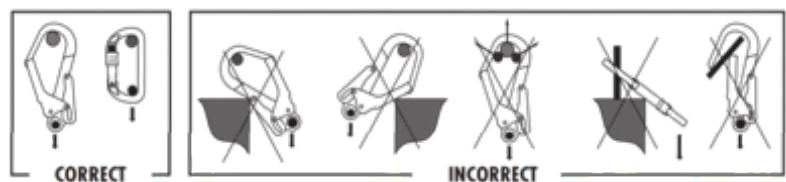

RATCHET LOAD BINDER & HOOK

RATCHET LOAD BINDER

- Drop forged/cast steel, quenched and tempered.
- Painted finish.
- Fitted with hooks and special securing device.
- Marked with size, lashing capacity and manufacturers mark

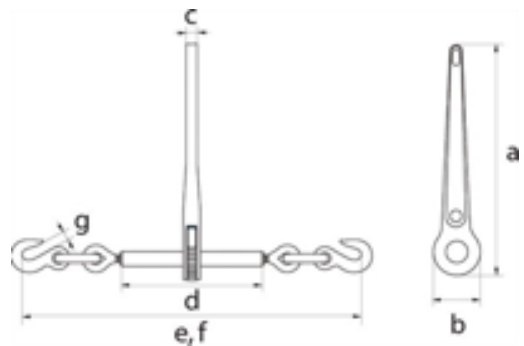

SIZE IN	WLL	DIMENSIONS (mm)							WEIGHT KG/PC
		A	B	C	D	E	F	G	
5/16" - 3/8"	5400LBS	355	66	16	254	750	580	13	4.7
3/8" - 1/2"	9200LBS	355	66	16	254	770	600	16	5.15
1/2" - 5/8"	13000LBS	355	66	16	254	840	685	19	6.6

GRADE 70 GRAB HOOK

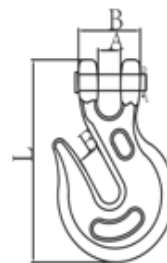

SIZE IN	WLL	DIMENSIONS (mm)				WEIGHT KG/PC
		A	B	E	L	
5/16" - 8mm	4700LBS	10	30.5	11	93	0.4
3/8" - 10mm	6600LBS	13	35	12.7	114.5	0.5
1/2" - 13mm	11300LBS	19	47	17	144	1
5/8" - 16mm	15800LBS	23	56	20	177	2

PALLET TRUCKS



- Professional heavy-duty pallet trucks
- Double rear rollers
- Tapered fork tips with guide entry rollers
- Easy to Steer and manoeuvre
- Wheels & rollers manufactured by nylon

Code	Capacity	Minimum Lowered Fork Height (mm)	Fork Size (mm)		
			Width Over Forks	Length	Fork Width
APTS2.5	2.5 tonne	75	550	1100	160
APTS3	3 tonne	75	550	1100	160
APTS5	5 tonne	75	500	1100	160

RATCHET LASHING BELT



- Min break strength: 500kg – 12000
- Sizes :25mm, 50mm, 75mm & 100mm
- Standard: EN12195-2
- High quality hard wearing polyester yarn
- Heavy duty ratchet
- Lengths: As per the requirement



SITE TROLLEY



- Site Trolley Heavy duty
- SWL: 1000kg
- Pneumatic Tyres
- 14" diameter wheels with bearings
- Bed dimensions 1200 x 765mm
- Solid steel construction with heavy duty wooden bed

ATTA WEBBING SLING





					
	Straight Pull	Choke Lift	basket Lift 0 to 7°	basket Lift 0 to 45°	basket Lift 45° to 60°
Colour	tonne	tonne	tonne	tonne	tonne
Violet	1	0.8	2	1.4	1
Green	2	1.6	4	2.8	2
Yellow	3	2.4	6	4.2	3
Grey	4	3.2	8	5.6	4
Red	5	4.0	10	7.0	5
Brown	6	4.8	12	8.4	6
Blue	8	6.4	16	11.2	8
Orange	10	8.0	20	14.0	10
Orange	12	9.6	24	16.8	12
Orange	15	12.0	30	21.0	15
Orange	20	16.0	40	28.0	20



- Manufactured from 100% high tenacity polyester material & high tenacity polyester yarn
- With either soft becket eyes or metal (reevable or non-reevable) terminal fittings
- Working load limits from 0.5t to 24t
- Available length upon request
- Multi-leg slings also available
- Protective sleeves are readily available
- A soft alternative to wire or chain
- Standard BS EN 1492-1
- Safety factor 7:1

ATTA ROUND SLING



					
	Straight Pull	Choke Lift	basket Lift 0 to 7°	basket Lift 0 to 45°	basket Lift 45° to 60°
Colour	tonne	tonne	tonne	tonne	tonne
Violet	1	0.8	2	1.4	1
Green	2	1.6	4	2.8	2
Yellow	3	2.4	6	4.2	3
Grey	4	3.2	8	5.6	4
Red	5	4.0	10	7.0	5
Brown	6	4.8	12	8.4	6
Blue	8	6.4	16	11.2	8
Orange	10	8.0	20	14.0	10
Orange	12	9.6	24	16.8	12
Orange	15	12.0	30	21.0	15
Orange	20	16.0	40	28.0	20
Orange	30	24.0	60	42.0	30

- Manufactured from high tenacity polyester yarn.
- Covered by a seamless tightly woven, heavy duty polyester tubular sleeve.
- Wear sleeves readily available for round slings
- Standard BS EN 1492-2
- Safety factor 7:1

GRADE 80 CHAIN SLING



- Ranging from 1.5 tonne to 66.8 tonne
- Can be single leg, 2 leg, 3 leg & 4 leg
- Can be assembled to your own requirements
- Standard BS EN 818 - 1 & 4

Chain Size (mm)	Single leg (t)	Two Leg (t)		Three & Four Leg (t)		Endless (t)
		0-45°	45°-60°	0-45°	45°-60°	
7	1.5	2.1	1.5	3.15	2.2	2.4
8	2.0	2.8	2.0	4.2	3.0	3.2
10	3.15	4.4	3.15	6.7	4.7	5.0
13	5.3	7.5	5.3	11.2	8.0	8.5
16	8.0	11.2	8.0	16.8	11.8	12.8
20	12.5	17.0	12.5	26.2	19.0	20.0
22	15.0	21.2	15.0	31.5	22.0	24.0
26	21.2	30.0	21.2	45.0	31.5	33.9
32	31.5	44.5	31.5	66.8	47.5	50.4

WIRE ROPE SLING



IWRC Construction - 1960 Grade - Class 6x19, Class 6x36

Rope Diameter mm	Single Leg Tonne	Leg Angle 0°- 45°		Leg Angle 45°- 60°		Minimum Break Load Tonne	Proof Load Per Leg at 0 degrees Tonne
		2 Leg Tonne	3 & 4 Leg Tonne	2 Leg Tonne	3 & 4 Leg Tonne		
8	0.82	1.1	1.7	0.82	1.2	4.1	1.64
9	1.0	1.4	2.1	1.0	1.5	5.2	2.0
10	1.3	1.8	2.7	1.3	1.9	6.42	2.6
11	1.5	2.1	3.1	1.5	2.2	7.77	3
12	1.8	2.5	3.8	1.8	2.7	9.25	3.6
13	2.1	2.9	4.4	2.1	3.1	10.8	4.2
14	2.5	3.5	5.2	2.5	3.7	12.6	5.0
16	3.3	4.6	6.9	3.3	4.9	16.4	6.6
18	4.1	5.7	8.6	4.1	6.1	23	8.2
19	4.6	6.4	9.6	4.6	6.9	23.1	9.2
20	5.1	7.1	10.7	5.1	7.6	28.4	10.2
22	6.2	8.7	13.0	6.2	9.3	31.1	12.4
24	7.4	10.3	15.5	7.4	11.1	41	14.8
26	8.6	12.0	18.0	8.6	12.9	43.4	17.2
28	10.0	14.0	21.0	10.0	15.0	55.8	20.0
32	13.1	18.3	27.5	13.1	19.7	72.9	26.2
35	15.7	22.0	33.0	15.7	23.6	87.2	31.4
36	16.6	23.2	34.9	16.6	24.9	92.2	33.2
38	18.5	25.9	38.9	18.5	27.8	103	37.0
40	20.5	28.7	43.0	20.5	30.8	114	41.0
44	24.8	34.7	52.1	24.8	37.2	138	19.6
48	29.5	41.3	62.0	29.5	44.3	164	59.0
52	34.7	48.6	72.9	34.7	52.1	193	69.4
54	37.2	52.1	78.1	37.2	55.8	207	74.4
56	40.1	56.1	84.2	40.1	60.02	223	80.2
60	46.0	64.4	96.6	46.0	69.0	256	92.0
64	54.2	75.9	114	54.2	81.3	301	108.2
71	64.8	90.7	136	64.8	97.2	360	129.6
77	76.5	107	161	76.5	115	425	153.0

- Standard BS EN 13414-1

LiftinGear
Premier Lifting & Handling Products

CHAIN BLOCKS

Chain Blocks

- New improved lightweight design.
- Guided hand chain cover reduces hand chain snagging during use.
- Double pawl brake system.
- High quality bearings for long life and easy operation.
- High Quality Grade 80 load chain.
- Heavy duty safety catches.
- Load chain also available with zinc plating.

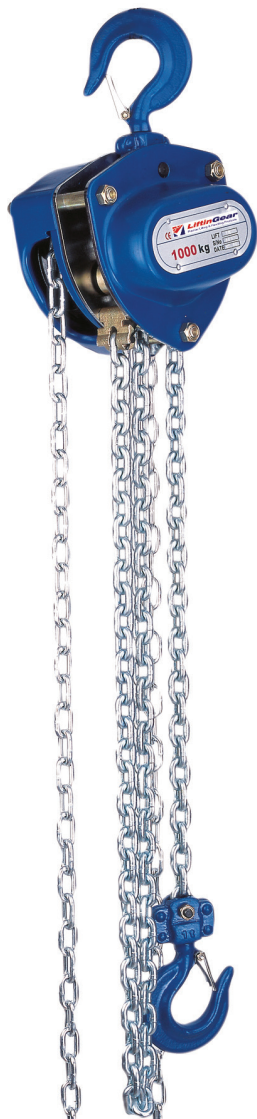

1000kg

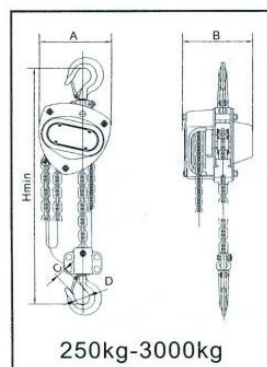
500kg / 1 tonne
Available in Matte Black
for event rigging

250kg-3000kg

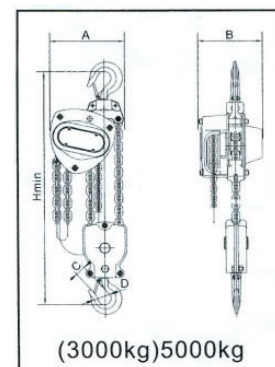

(3000kg)5000kg

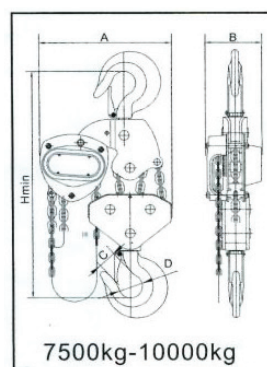

7500kg-10000kg

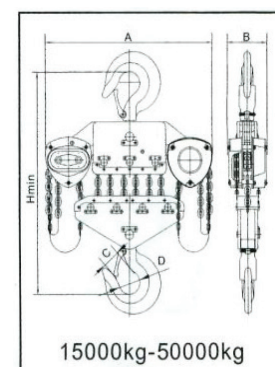

15000kg-50000kg

Capacity (kg)		250	500	1000	1500	2000	3000	3000	5000	7500	10000	15000	20000	30000	50000
Standard Lift (m)3		3	3	3	3	3	3	3	3	3	3	3	3	3	3
No. Of Load Chain Falls		1	1	1	1	1	1	2	2	3	4	6	8	12	20
Load Chain Diam Øxmm		4X12	5X15	6X18	7X21	8X24	10X30	7X21	10X30	10X30	10X30	10X30	10X30	10X30	10X30
DIMENSIONS	A(mm)	120	146	161	182	202	255	230	250	430	460	718	840	870	746
	B(mm)	114	138	154	176	177	205	176	189	189	189	189	189	455	660
	C(mm)	21	23	27	33	35	39	39	45	47	59	70	80	85	110
	D(mm)	31	35	40	45	50	55	55	65	67	85	95	106	110	128
	Hmin (mm)	280	350	383	442	485	554	565	688	760	780	950	970	1400	2480

LEVER HOISTS

Lever Hoists LHLG

- Lightweight & compact.
- Ease of use due to optimal gear ratio.
- Easy pull through of load chain (not when loaded).
- Rubberised handle for comfort.
- All Lever Hoists fitted with 1.5 metres of load chain (longer available).
- Quality high strength load chain, 360° swivel latch hooks.
- Lifting chain length can be altered to your requirements.
- Heavy duty safety catch.



750kg
1500kg
3000kg

1000 kg

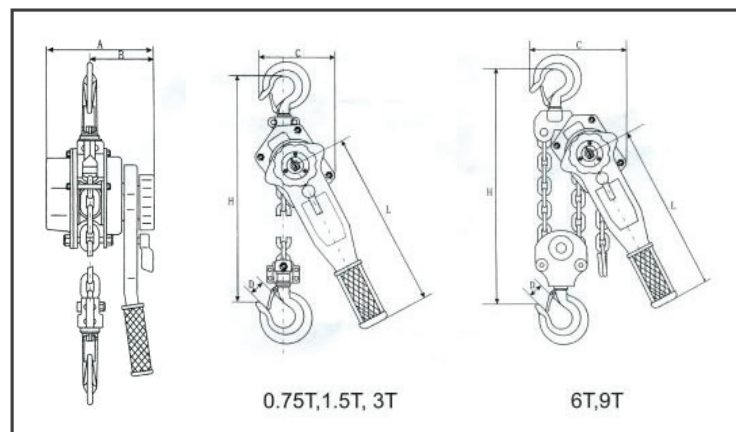

Product Code	Capacity	Standard H.O.L	No. Of Load Chain Falls	Load Chain Diam.	Head room Hook to Hook	Length Of Lever Handle	DIMENSIONS			
	(kg)	(m)		Ø x (mm)	(mm)	(mm)	A	B	C	D
LH750x1.5M	750	1.5	1	6X18	320	280	148	90	136	30
LH1500x1.5M	1500	1.5	1	8X24	380	410	172	98	160	35
LH3000x1.5M	3000	1.5	1	10X30	480	410	200	115	180	40
LH6000x1.5M	6000	1.5	2	10X30	600	410	200	115	235	50
LH9000x1.5M	9000	1.5	3	10X30	700	410	203	115	316	85



BEAM CLAMPS & TROLLEYS

Beam Clamps

- Adjustable Beam Clamp.
- Pivoting eye to attach a hoist.
- Easily adjustable to fit most beams by turning central threaded adjusting bar.

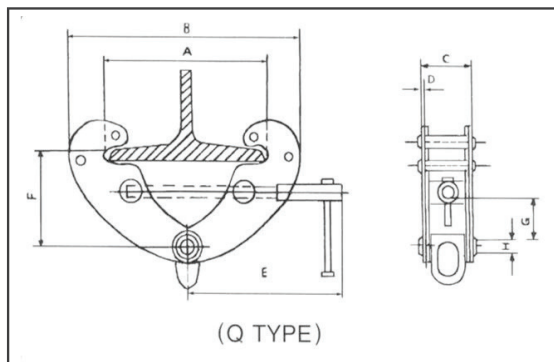

Product Code	Capacity Tonnes	Adjustable Beam width (mm)	A Max	B		C	D	E	F		G Min	H	Weight (kgs)
				Min	Max				Min	Max			
BC1T	1	70-245	270	183	375	66	4	210	165	102	25	20	4.4
BC2T	2	70-245	270	138	375	74	6	210	165	102	25	20	5.1
BC3T	3	70-355	365	240	520	103	8	258	225	125	45	22	10.5
BC5T	5	70-355	365	240	520	111	10	258	225	125	45	28	17
BC10T	10	80-350	365	250	520	120	12	280	230	160	50	38	19

QUALITY IS OUR STRENGTH
STRENGTH IS OUR BUSINESS



BEAM CLAMPS & TROLLEYS

F-Type Plain Trolley

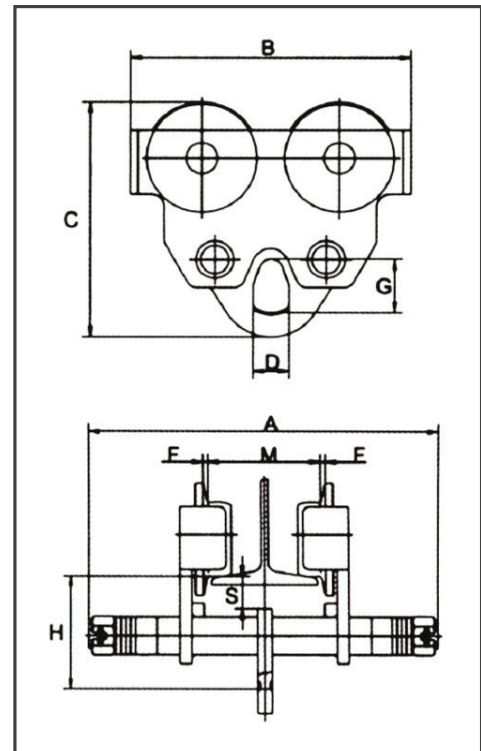
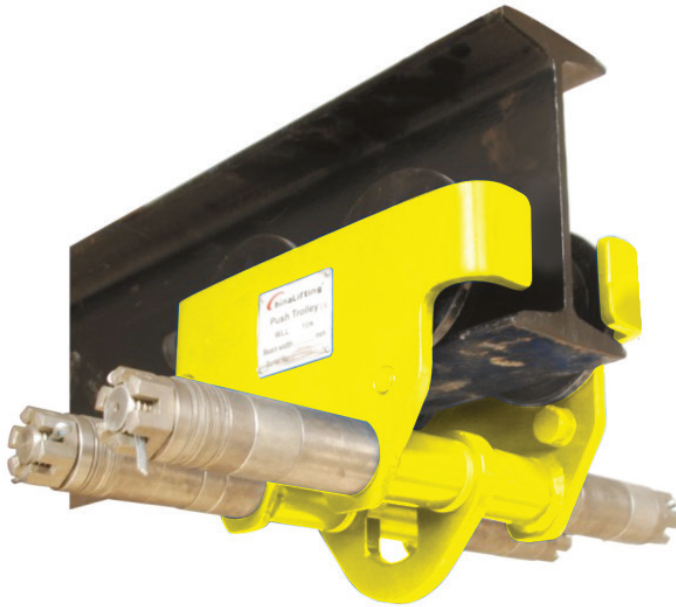

Item No.		01271	01272	01273	01274	01275	01276	01277	01278	01279	01280	01270
Capacity Load	(T)	0.5	1	1.5	2	3	5	8	10	16	20	30
Test Load	kN	7.35	14.71	22.06	29.42	44.13	61.29	98.06	122.58	196.12	245.17	367.74
Min. Radius of Curve	(m)	0.8	0.9	1	1	1.2	1.3	2	2	3.5	3.5	6
A	a	236	303	310	317	333	355	372	378	449	449	-
	b	286	405	412	419	435	457	474	480	551	551	610
	B	194	236	250	268	322	362	426	442	555	555	710
	C	176	196	210	226	266	301	388	396	498	498	608
	H	75	96	102	109	124	142	185	190	236	233	285
	S	30	38	38	38	40	42	45	45	65	58	65
	D	28	32	36	42	52	62	72	72	95	95	105
	G	32	40	45	52	63	74	110	110	135	135	155
	F	1.5 - 3	1.5 - 3	1.5 - 3	1.5 - 3	1.5 - 3	1.5 - 3	2 - 3.5	2 - 3.5	2 - 3.5	2 - 3.5	2 - 3.5
I-beam width range - mm	a	50 - 152	64 - 203	74 - 203	88 - 203	100 - 203	114 - 203	124 - 203	124 - 203	136 - 203	136 - 203	-
	b	50 - 203	64 - 305	74 - 305	88 - 305	100 - 305	114 - 305	124 - 305	124 - 305	136 - 305	136 - 305	175 - 305

LiftinGear
Premier Lifting & Handling Products

BEAM CLAMPS & TROLLEYS

F-Type Geared Beam Trolley

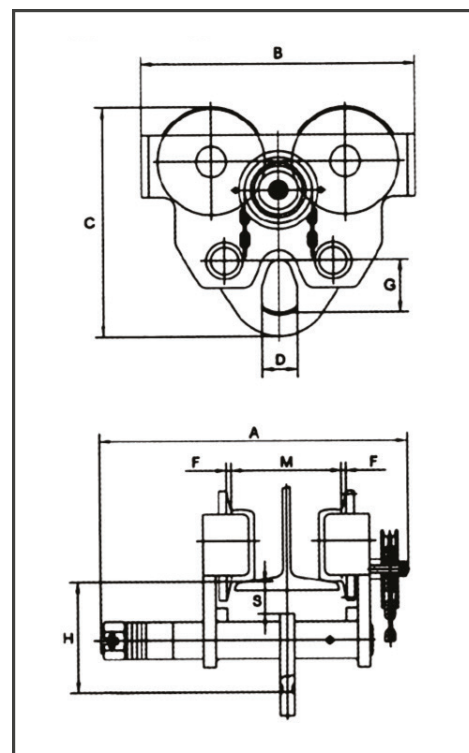

Item No.		01271A	01272A	01273A	01274A	01275A	01276A	01277A	01278A	1279A	01280A	01270A	01269A
Capacity Load	(T)	0.5	1	1.5	2	3	5	8	10	16	20	30	40
Test Load	kN	7.35	14.71	22.06	29.42	44.13	61.29	98.06	122.58	196.12	245.17	367.74	490.34
Running Height	(m)	2.5	2.5	2.5	2.5	2.5	2.5	2.5	2.5	2.5	2.5	2.5	3
Chain Pull to Lift Full Load	(N)	25	50	70	90	95	140	200	240	240	250	250	320
Min. Radius of Curve	(m)	0.8	0.9	1	1	1.2	1.3	2	2	3.5	3.5	6	7
A	a	270	334	337	343	357	373	400	406	498	500	-	-
	b	322	436	439	445	459	475	502	508	602	604	674	758
	B	194	236	250	268	322	362	426	442	555	555	710	800
	C	176	196	210	225	266	301	388	396	498	498	608	748
	H	75	96	102	109	124	142	195	190	236	233	285	388
	S	30	38	38	38	40	42	45	45	65	58	65	77
	O	28	32	36	42	52	62	72	72	95	95	105	165
	G	32	40	45	52	63	74	110	110	135	135	155	250
	F	1.5 - 3	1.5 - 3	1.5 - 3	1.5 - 3	1.5 - 3	1.5 - 3	2 - 3.5	2 - 3.5	2 - 3.5	2 - 3.5	2 - 3.5	2 - 3.5
I-beam width range - mm	a	50 - 152	64 - 203	74 - 203	88 - 203	100 - 203	114 - 203	124 - 203	124 - 203	136 - 203	136 - 203	-	-
	b	50 - 203	64 - 305	74 - 305	88 - 305	100 - 305	114 - 305	124 - 305	124 - 305	136 - 305	136 - 305	175 - 305	190 - 320

ALLOY SHACKLES

Alloy Shackles

- Tested & Certified
- High Quality
- Fully Embossed for Easy Identification
- Safety Factor 6:1
- Galvanised Finish



(meets the performance requirements for RR-C-271 BS EN13889)

W.L.L. Tons	A mm	B mm	C mm	D		2E mm	WEIGHT EACH Kgs
				BOW mm	DEE mm		
0.33	5	6	9.5	22	-	16	0.02
0.5	7	8	12	29	25	20	0.05
0.75	9	10	13.5	32	27	21	0.11
1.00	10	11	17	36.5	31	26	0.15
1.5	11	12	18.5	43	37	29	0.21
2.00	15.5	16	22	51	43	32	0.37
3.25	61	19	27	64	51	43	0.65
4.75	19	22	31	76	59	51	1.06
6.5	22	25	36	83	73	58	1.56
8.5	25	28	43	95	85	68	2.32
9.5	28	32	47	108	90	75	3.28
12.00	32	35	51	115	94	83	4.51
13.5	35	38	57	133	115	92	5.93
17.00	38	42	60	146	127	99	7.89
25.00	45	50	74	178	149	126	13.4
35.00	50	57	83	197	171	138	18.85
55.00	65	70	105	254	208	180	37.86
85.00	90	96	146	381	-	-	60

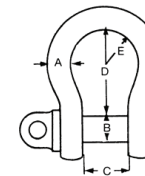
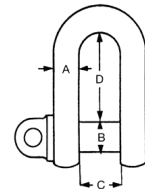

W.L.L. Tons	A mm	B mm	C mm	D		2E mm	WEIGHT EACH Kgs
				BOW mm	DEE mm		
0.5	7	8	12	29	-	20	0.07
0.75	9	10	13.5	32	-	21	0.13
1.00	10	11	17	36.5	-	26	0.17
1.5	11	12	18.5	43	-	29	0.25
2.00	13.5	16	22	51	43	32	0.44
3.25	16	19	27	64	51	43	0.79
4.75	19	22	31	76	59	51	1.26
6.5	22	25	36	83	73	58	1.88
8.5	25	28	43	95	85	68	2.78
9.5	28	32	47	108	90	75	3.87
12.00	32	35	51	115	94	83	5.26
13.5	35	38	57	133	115	92	6.94
17.00	38	42	60	146	127	99	8.79
25.00	45	50	74	178	149	126	14.99
35.00	50	57	83	197	171	138	20.65
55.00	65	70	105	254	203	180	41.05
85.00	75	80	127	330	230	190	62.24
120.00	90	95	146	381	267	238	110

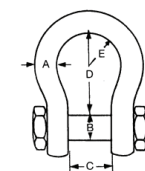
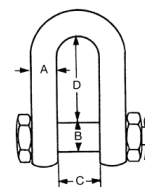



LiftinGear

Premier Lifting & Handling Products

COLLARED EYEBOLTS

Metric Thread

BS EN ISO 3266:2010

	VERTICAL SWL TONNES	A mm	B mm	C mm	D mm	E mm	F mm	G mm	WEIGHT EACH KGS
*	0.10	6	22	7	15	9	20	18	0.06
*	0.15	8	22	7	15	9	20	18	0.06
*	0.25	10	22	7	15	9	20	18	0.06
	0.40	12	22	7	15	9	20	18	0.06
*	0.50	14	29	10	20	12	26	23	0.15
	0.80	16	29	10	20	12	26	23	0.15
*	1.00	18	36	12	24	14	32	28	0.27
	1.60	20	40	14	27	16	36	32	0.38
*	1.60	22	45	14	30	17	40	35	0.54
	2.50	24	52	17	35	21	46	40	0.85
*	2.50	27	58	20	39	23	52	46	1.13
	4.00	30	65	22	44	26	58	51	1.62
*	4.00	33	72	24	48	29	64	56	2.37
	6.30	36	81	27	54	32	72	63	3.12
*	6.30	39	86	29	57	33	76	67	3.81
	8.00	42	101	34	68	40	90	79	6.27
*	8.00	45	101	34	68	40	90	79	6.45
*	10.00	48	101	34	68	40	90	79	6.51
	12.50	45	115	38	76	46	102	89	9.58
	16.00	56	128	43	86	51	114	100	12.99
	20.00	64	144	48	96	58	128	112	18.20

Sizes marked with * are additional & proportional to the specification

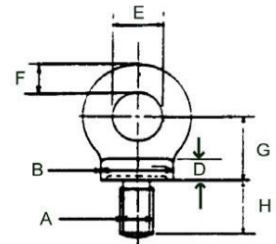

Wire Rope Clips

Wire rope dia	Bow dia	Overall length of bow	Inside width	Length of thread	Length of base	Thickness of base	Height of base	Approx. weight per 100 pcs
D	d	a	C	C	2r	Screw pin	Safety pin	
inches	mm	mm	mm	mm	mm	mm	mm	kg
1/8	5	24	12	11	24	21	10	2
3/16	6	31	15	13	29	24	13	4
1/4	8	34	19	13	37	30	17	8
5/16	10	45	22	19	43	33	18	14
3/8	11	49	26	19	49	42	25	19
7/16	12	60	30	25	58	46	26	31
1/2	13	61	30	26	58	48	27	14
9/16	14	72	33	32	63	52	31	19
5/8	14	74	33	32	64	52	33	31
3/4	16	86	38	37	72	57	37	68
7/8	19	98	45	40	80	62	40	108
1	19	108	48	46	88	67	44	113
1 1/8	19	117	51	51	91	72	48	140
1 1/4	22	130	59	54	105	79	56	207
1 3/8	22	140	60	59	108	79	58	234
1 1/2	22	147	60	60	112	86	64	266
1 5/8	22	161	70	67	121	92	67	329
1 3/4	29	175	78	74	134	97	78	441
2	32	195	86	78	152	113	87	603
2 2/4	32	208	98	81	162	116	100	707
2 1/2	32	227	105	87	168	119	113	806
2 3/4	32	243	112	91	174	127	124	1000
3	38	271	121	104	194	135	136	1440

Wire Rope Clips
Generally to U.S. Fed. Spec. FF-C450

- Material : SAE 1035 OR SAE 1045, high tensile steel.
- Finish : hot dipped galvanised

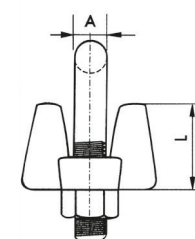
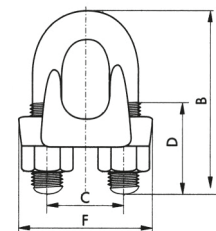

WALMAG Permanent Lifting Magnets

WALMAG Permanent Lifting Magnets



Magnetic lifting made easy with WALMAG-series



- State of the art two-pole design.
- Tremendous lifting capacity thanks to High-Energy Neodymium magnets.
- Increased airgap capability.
- Easy ON/OFF switching.
- Extremely compact, low dead weight.
- Robust, low maintenance.
- Smart design.



Specifications

Model	NEO 125	NEO 250	NEO 500	NEO 1000	NEO 2000
Nominal* Lift Capacity					
Flat Material [kg]	125	250	500	1000	2000
Round Material [kg]	50	125	250	500	1000
Tested** Break-Away Force [daN]	400	800	1600	3200	6000
Ø min./max. [mm]	50/100	60/200	65/270	100/300	150/350
Length [mm]	95	151	246	316	480
Width [mm]	60	100	120	148	165
Height [mm]	110	168	168	216	251
Mass [kg]	3	10	19	36	90

Nominal lift capacity includes a safety factor of at least 3
Capacity varies with workpiece material, thickness and surface equality.
** Tested on a ground , 50mm thick , mild steel plate

ELECTRIC CHAIN HOIST



Electric Chain Hoist

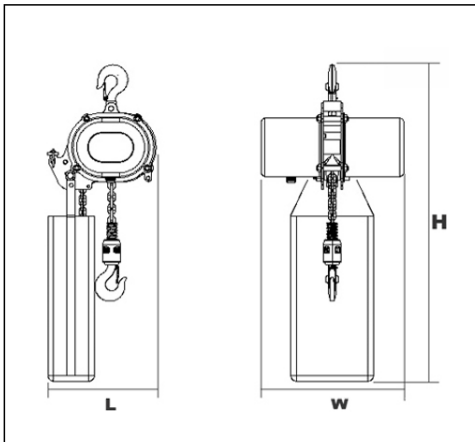

High Performance

Model	Max (Kg)	Power (Voltage)			Phase	Speed (M/min)		Trolley Motor (HP)
						50Hz	60Hz	
DU - 102C	2000	220	380	440		18	22	0.5

Model	Capacity (Kg)	Power (Voltage)			Phase	Lift (Meter)	Lift (Meter)	Chain (Falls)	Speed (M /min)		Motor (HP)	Load Chain (mm)
									50Hz	60Hz		
DU - 750	750	220	380	440	3	3	3	1	5	6	2	7.1
DU - 905	1000	220	380	440	3	3	3	1	5	6	2	7.1
DU - 906	2000	220	380	440	3	3	3	2	2.5	3	2	7.1

WINCHES & ACCESSORIES

Snatch Blocks



- Greaseable load bearing.
- Greaseable swivel hook.
- Drop forged wheel.
- Shackle or Hook Fitting.

Item No.	Capacity (Tonne)	Sheave Size (inch/mm)	Wire rope Diameter (mm)
SBS/SBH - 2	2	3/75	7 - 9
SBS/SBH - 4	4	4.5/115	10 - 12
SBS/SBH - 6	8	6/150	20 - 22
SBS/SBH - 8	8	8/200	20 - 22
SBS/SBH - 10	10	10/250	24 - 26
SBS/SBH - 12	12	12/300	24 - 26
SBS - 15	15	12/300	26 - 28
SBS - 22	22	14/355	28 - 32
SBS - 30	30	44/600	44

BS - Snatch Block Shackle Type
SBH - Snatch Block Hook Type

Industrial Hand Winch

Product code	WLL (kg)	Wire Rope (mm) Length(m)	No. of layers	A (mm)	A (mm)	A (mm)	A (mm)	A (mm)	Speed
WINCHI250	250	5 20	4	150	330	150	200	240	1
WINCHI500	500	6.8 25	4	180	360	180	260	240	1
WINCHI1000	1000	9 35	4	300	490	300	300	370	1

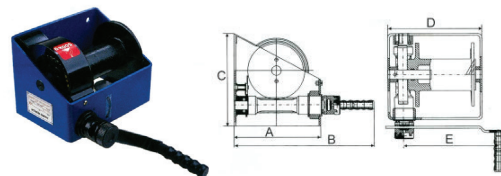

Wire Rope Winches

- Easy & safe to operate.
- Very precise movement.
- Light to carry due to aluminium body.
- Coated finish.
- Easy replaceable overload pins (extra supplied).
- Easy to clean & service.
- Can be used for lifting, pulling & tensioning.
- Steel model available.



Product Code	WRW800	WRW1600	WRW3200	WRW5400
Lifting KG	800	1600	3200	5400
Pulling KG	1200	2500	5000	10800
Weight Inc 20Mtr Rope	12 Kg	25 Kg	46 Kg	97 Kg
Rope Diameter	8.3 MM	11 MM	16 MM	20 MM

WINCHES & ACCESSORIES

Electric Wire Winch

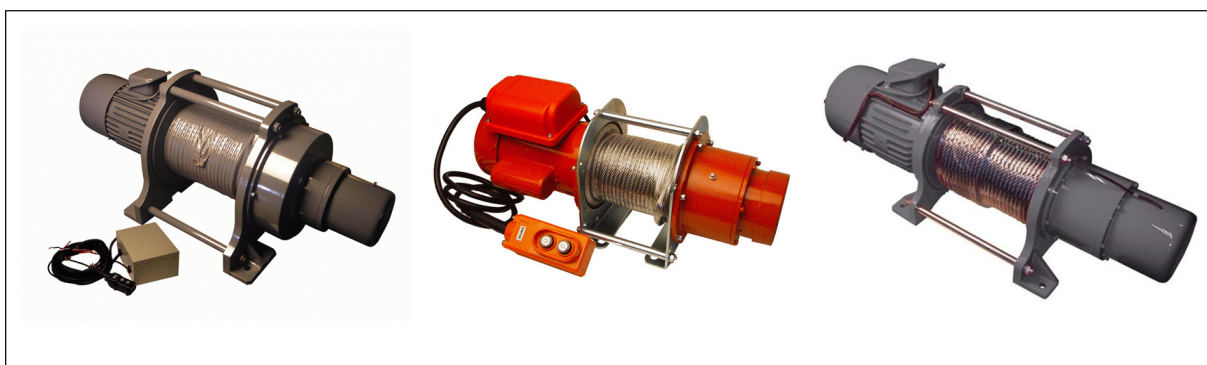

High Performance

Usage:

Fit for various construction workers, civil engineering, general factories, plumbing, coating, scaffolding, warehousing, buildings, domestics, farming and fishing industries, stores and even more.

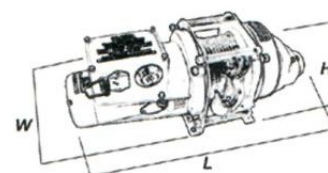

Features:

Driving the heat treated gear with bearings features durable performance and anti-wear. Planetary and anti-wear gears. Compact and load sharing minimizes size, weight, and cost. Full depth spur gear planetary reductions ensure quiet and long life. Gear box provides strength, durability and non-worry of breakage of structure. Ball bearings high efficient and heavy duty bearings provide long life. Brake designed for both static and dynamic loading. Brake will automatically apply in the event of power loss. Large friction surface area. No adjustments or serving requirement. Induction motor IEC induction motor mounted provides reality available, cost effective and service spares availability worldwide.

Model	Capacity (Kg)	Power (Voltage)			Phase	Wire Rope (mm)	Wire Rope Lift (Meter)	Speed (M/min)		Motor (HP)
								0Hz	60Hz	
DU - 201	150	220			1	5	25	15	18	0.5
DU - 202	200	220	220	380		6	30	15	18	0.5
DU - 204	250	220	220	380		6	30	15	18	0.8
DU - 221 H	250	220	220	380		7	30	38	40	1.5
DU - 205	300	220	220	380		7	30	15	18	1
DU - 208	350	220	220	380		7	30	15	18	1.5
DU - 223H	350	220	220	380		7	45	38	45	2
DU - 210	500	220	220	380		8	45	21	25	2
DU - 212	1000	220	380	440		10	45	12	15	3
DU - 2K	2000	220	380	440		12	45	12	15	5
DU - 213	2000	220	380	440		12	70	12	15	5
DU - 3K	3000	220	380	440		14	45	12	15	7.5
DU - 214	3000	220	380	440		14	70	12	15	7.5
DU - 215	5000	220	380	440		16	70	12	15	10

WINCHES & ACCESSORIES



Electric Mini Wire Winch

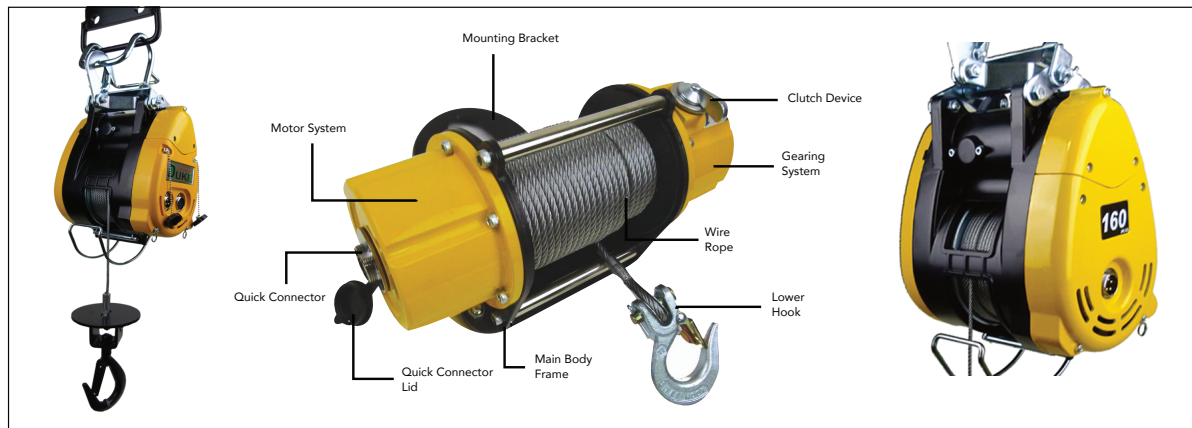

Usage:

Fit For Various Construction Workplaces, Civil Engineering, General Factories, Plumbing, Coating Scaffolding, Warehousing, Buildings, Domestics, Farming, And Fishing Industries, Stores, and Even More.

Features:

Mini winch is compact and lightweight design allow mounting convenience. When rope touches the over-winding limit lever, hoisting is automatically stopped. An over reverse-winding limit lever stops the motor when the rope is reverse winging. Double safety brake devices, dynamic & electromagnet brakes perform instant & safety brakes. It operates on household power source. 360° universal joint saddle hook with safety latch. Plug-in cords allow portability with ease.

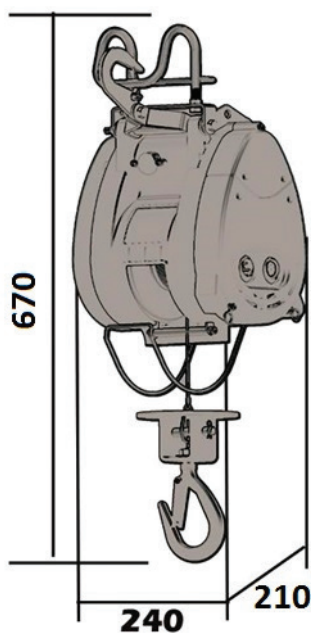

Model	L (mm)	W (mm)	H (mm)	Package Box			Cu. Ft	N. W (Kgs)	G.W (Kgs)
				L (mm)	W (mm)	(mm)			
DU - 75A	280	180	470	400	300	250	1'	8	15
DU - 160A	240	180	660	500	250	330	1.45'	15	23
DU - 160B	240	210	470	500	250	330	1.45'	15	23
DU - 180A	240	180	660	500	250	330	1.45'	15	23
DU - 230A	240	180	660	500	250	330	1.45'	16	24
DU - 250A	240	210	670	500	250	330	1.45'	20	28
DU - 300A	240	210	670	500	250	330	1.45'	20	28
DU - 260L	240	180	660	500	250	330	1.45'	15	26
DU - 330L	240	210	670	500	250	330	1.45'	20	31
DU - 160TH	240	180	660	500	250	330	1.45'	15	23
DU - 230TH	240	180	660	500	250	330	1.45'	15	23
DU - 250TH	240	210	670	500	250	330	1.45'	20	28
DU - 300TH	240	210	670	500	250	330	1.45'	20	28

WINCHES & ACCESSORIES

Hoist Usage, Features, Specification



Usage:

It is suitable for Engineering Hoisting, Factory Lifting Operation, Civil Engineering Water Electrical wiring & piping Installation, Warehouse Shipping Purpose, etc. The application is very wide. It is also good for Lifting, Hoisting, Pulling, etc. Operation suitable, to save labor, and save time, with high efficiency.

Features:

Motor System:

1. Applied with industrial grade high efficiency mice cage type induction motor.
2. With multi-output wires type, with 3 types of voltages options available.
3. Enameled wires with heat resistance up to 180 degrees Celsius, it is specially designed for long time hoisting purpose.

Brake System:

1. With unique designed brake systems for motor section and gear section.
2. Applied with high friction coefficient disk type brake lining, no adjustment required.
3. When there is power failure or you need to promptly to start brake stop, then safety is guaranteed. Operating life is more than 1 million times of brake.

Electric Control System:

1. With 24V low voltage control, there is no electric shock worry during rain. It is safe and stable.
2. Electric wiring cabinet with big current cartridge type PCB and Japanese type relay, with high quality, fast to change. Operating life is more than 1 million times of contact.

Safety System:

1. When chain is operating to an upper limit or lower limit, power will be disconnected automatically.
2. Inside with protect device for phase shortage, phase reverse, it will be stopped automatically when three phases power is short of phase and cannot use, to prevent motor burning from phase storage.
3. If three phases power is phase reverse, it will automatically stop. Safety is guaranteed.

Chain Specification:

1. With genuine chain imported from Japan FEC company, which is manufactured by reputed manufacturers in this filed worldwide.
2. Made from alloy steel material with 80 grade and with 3 times safety coefficient.

Gear System:

1. With planetary speed reducing gear which has most efficiency.
2. The planetary gear unit is based on two steps type, the secondary step output gear unit is based on a four piece of running idle wheel made by alloy steel with heat treatment for share force, the life is four times more longer than traditional transmission.
3. Gear box is made from FDC-45C casting iron material by one-piece formation, with high tenacity, by a computer CNC machining, with high accuracy and low noise.



WINCHES & ACCESSORIES



Hoist Usage, Features, Specification

Main Body Frame:

1. With 5mm high strength steel plate to support frame of hoist.
2. The strength is three times higher than normal aluminium alloy beam.
3. Applied with electric coating that is better to avoid rust, good for operation under badly environment when temperature is from minimum 15 degree Celsius to 65 degree Celsius.

Housing Section:

1. Made from high strength steel plate and one-piece formed by big tonnage hydraulic power press. Absolutely without gap or joint.
2. Completely sealed with water resistance grade up to IP 65.
3. With automobile grade powder coating, and appearance is beautiful.
4. With compact structure, effective to add upper, lower hoisting distance.

Upper Lower Hook Unit:

1. Made from alloy steel material by hot forging formation, with high strength, safety coefficient is four times.
2. Lower hook inside is applied with ball bearing to against 360 degree rotation. Danger will be happened during chain was twisted when it is hoisting heavy goods.

Control Switch:

1. With indirect type push button made in Taiwan, volume is small, easy to operate.
2. With water resistance grade up to IP 65, operating life is more than 1 million times.
3. Control wires is based on electric cable mixed with steel wires, it is durable for pulling and not easy to break.

Specification

Model	L (mm)	W (mm)	H (mm)	Package Box			Cu. Ft	N. W (Kgs)	G.W (Kgs)
				L (mm)	W (mm)	H (mm)			
DU - 750	430	290	600	530	420	470	3.7	45	55
DU - 950	430	290	600	530	420	470	3.7	45	55
DU - 906	430	290	600	530	420	470	3.7	55	66
DU - 102C	470	295	241	570	400	340	3.7	39	40

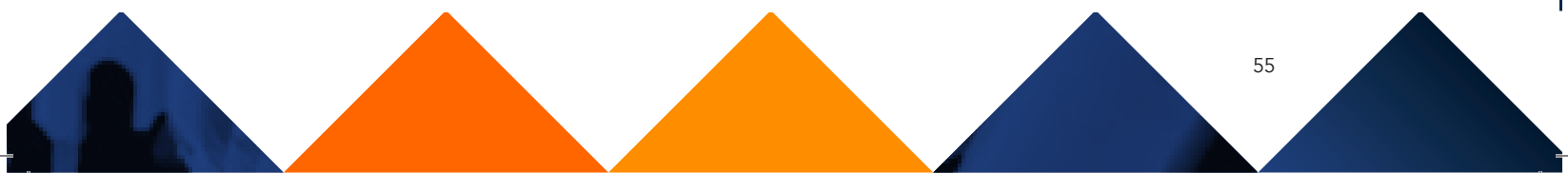

CAMLOK

Camlok® Lifting Clamps



Bottom/Side
Container lifting Lug



Top Container Lifting Lug



Universal Plate Clamp



PH Pipe Hook



DCV 500 Drum Clamp



CFM Series Crane Fork



SC92 Beam Clamp



Horizontal Plate Clamp



Pulling Clamps

CLOSED SPELTER SOCKETS

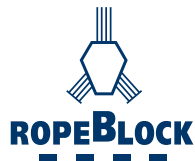

Closed Spelter Sockets

Quenched and tempered cast steel range with mechanical values
(Charpy-V > 42 Joule / -20°C) for tough and low temperature use.

- For wire rope diameter
6 - 203 mm (1/4" - 8").
- All spelter sockets have a
100% efficiency

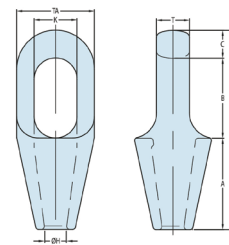

Model nr.		for wire Ø		Strand Ø		Ø Dimensions								Weight (kg)
		mm	inch	mm	inch	A	B	C	Ø H	K	T	TA	TL	
CSS 296	8	6-7	1/4	-	-	50	40	11	9,1	22	13	37	101	0,3
CSS 297	12	8-10	3/8	-	-	57	48	14	12,6	25	18	43	119	0,4
CSS 298	20	11-13	7/16 - 1/2	-	-	64	59	17,5	14,6	30	23	51	140	0,7
CSS 299	25	14-16	9/16 - 5/8	13	1/2	76	65	21	18,1	36	26	67	162	1,4
CSS 200	40	18-19	3/4	14-16	9/16 - 5/8	89	78	27	21,9	42	32	76	194	2,2
CSS 201	55	20-22	7/8	18-19	3/4	101	90	33	24,9	47	38	92	224	3,8
CSS 204	75	23-26	1	20-22	7/8	114	103	36	28,8	57	44	104	253	5,4
CSS 207	90	27-30	1 1/8	23-26	1	127	116	39	32,9	65	51	114	282	7
CSS 212	125	31-36	1 1/4 - 1 3/8	27-28	1 1/16 - 1 1/8	139	130	43	39,2	71	57	126	312	10
CSS 215	150	37-39	1/2	30-32	1 3/16 - 1 1/4	152	155	51	42,5	81	63	136	358	13
CSS 217	170	40-42	5/8	33-35	1 5/16 - 1 3/8	165	171	54	45,5	83	70	146	390	17
CSS 219	225	43-48	1 3/4 - 1 7/8	36-40	1 7/16 - 1 5/8	190	198	55	52,5	93	76	171	443	26
CSS 222	280	49-54	2 - 2 1/8	42-45	1 5/8 - 1 3/4	216	224	62	59,1	100	82	193	502	37
CSS 224	360	55-60	2 1/4 - 2 3/8	46-48	1 13/16 - 1 7/8	228	247	73	65,1	112	92	216	548	50
CSS 226	425	61-68	2 1/2 - 2 5/8	50-54	2 - 2 1/8	248	270	79	73,4	140	102	241	597	66
CSS 227	460	69-75	2 3/4 - 2 7/8	56-62	2 1/4 - 2 1/2	279	286	79	79,4	159	124	273	644	91
CSS 228	560	76-80	3 - 3 1/8	64-67	2 1/2 - 2 5/8	315	298	83	88,2	171	133	292	696	117
CSS 229	625	81-86	3 1/4 - 3 3/8	69-76	2 3/4 - 3	330	311	102	92,4	184	146	311	743	125
CSS 230	720	87-93	3 1/2 - 3 5/8	78-86	3 1/16 - 3 3/8	356	330	102	98,8	197	159	330	788	176
CSS 231	875	94-102	3 3/4 - 4	88-96	3 7/16 - 3 3/4	381	356	108	107,8	216	178	362	845	228
CSS 233	1200	108-115	4 1/4 - 4 1/2	98-110	3 7/8 - 4 5/16	450	425	125	129,5	235	190	405	1000	323
CSS 240	1400	120-130	4 3/4 - 5	112-124	4 7/16 - 4 7/8	500	525	125	147,1	260	200	450	1150	447
CSS 245	1600	135-140	5 1/4 - 5 1/2	125-132	4 15/16 - 5 3/16	540	495	150	153,9	290	220	520	1185	645
CSS 250	2000	142-153	5 3/4 - 6	133-143	5 1/4 - 5 5/8	585	530	170	171,1	305	240	545	1285	741
CSS 255	2220	154-165	6 1/4 - 6 1/2	144-154	5 11/16 - 6 1/4	630	565	175	185,1	330	250	575	1370	860
CSS 260	2500	166-178	6 3/4 - 7	155-166	6 1/4 - 6 3/4	680	590	180	199,1	330	270	595	1450	985
CSS 265	2800	180-191	7 1/4 - 7 1/2	167-179	6 9/16 - 7 1/16	725	620	190	213	350	290	625	1535	1183
CSS 270	3200	192-204	7 3/4 - 8	180-191	7 1/4 - 7 1/2	775	650	210	228,5	395	305	690	1635	1487

MBL = Minimum Breaking Load

The standard nish of our sockets is blue. Hot dipped galvanized is also available. Socket range CSS 296 until CSS 201 is delivered with galvanized finish, other finishes are available upon request. All sockets are provided with an EN 10204-2.1 declaration of conformity, EN 10204-3.1 material certificate and can be provided with a 2006/42/EC declaration where applicable.

OPEN SPELTER SOCKETS

Open Spelter Sockets

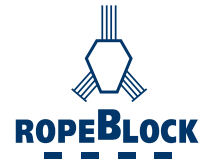

Quenched and tempered cast steel range with mechanical values (Charpy-V > 42 Joule /-20°C)

for to low temperature use. For wire rope diameter 6 - 203 mm (1/4" - 8").

- Pin securing by cotter pin or bolt securing by nut and cotter pin.
- Optional is a flange connection for use with a bend stiffener.
- All spelter sockets have a 100% efficiency.

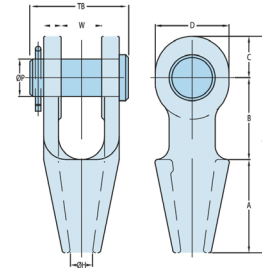

Model nr.	MBL (Mtons)	for wire Ø		Strand Ø		Dimensions(mm)										Weight (kg)
		mm	inch	mm	inch	A	B	C	D	Ø H	Ø P	T	TL	TB	W	
OSS 196 P	8	6-7	1/4	-	-	50	40	19	34	9	16	9	109	51	19	0,4
OSS 197 P	12	8-10	3/8	-	-	57	45	22	42	13	20	11	124	63	21	0,7
OSS 198 P	20	11-13	7/16 - 1/2	-	-	64	51	27	50	15	25	12	142	67	25	1
OSS 199 P	25	14-16	9/16 - 5/8	13	1/2	76	63	32	58	18	30	14	171	58	32	1,8
OSS 100 P	40	18-19	3/4	14-16	9/16 - 5/8	89	76	40	70	22	35	16	205	95	38	3
OSS 104 P	55	20-22	7/8	18-19	3/4	101	89	45	80	25	41	19	235	110	44	4,6
OSS 108 P	75	23-26	1	20-22	7/8	114	101	60	104	29	51	22	275	128	51	8
OSS 111 P	90	27-30	1 1/8	23-26	1	127	114	65	114	33	57	25	306	142	57	11
OSS 115 P	125	31-36	1 1/4 - 1 3/8	27-28	1 1/16 - 1 1/8	139	127	72	126	39	63	28	338	155	63	15
OSS 118 P	150	37-39	1 1/2	30-32	1 3/16 - 1 1/4	152	162	80	142	42	70	30	394	177	76	22
OSS 120	170	40-42	1 5/8	33-35	1 5/16 - 1 7/8	165	165	88	156	45	76	33	418	187	76	27
OSS 125 P	225	43-48	1 3/4 - 1 7/8	36-40	1 7/16 - 1 5/8	190	178	100	176	52	89	39	469	215	89	41
OSS 128 P	280	49-54	2 - 2 1/8	42-45	1 5/8 - 1 3/4	216	228	108	194	59	95	45	552	244	101	60
OSS 130 P	360	55-60	2 1/4 - 2 3/8	46-48	1 13/16 - 1 7/8	228	254	120	210	64	108	53	603	275	113	88
OSS 132 P	425	61-68	2 1/2 - 2 5/8	50-54	2 - 2 1/8	248	273	133	236	75	121	60	654	300	127	118
OSS 135 P	460	69-75	2 3/4 - 2 7/8	56-62	2 1/4 - 2 1/2	279	279	138	240	81	127	73	696	335	133	155
OSS 138 P	560	76-80	3 - 3 1/8	64-67	2 1/2 - 2 5/8	315	286	146	252	88	133	76	737	355	146	186
OSS 140 P	625	81-86	3 1/4 - 3 3/8	69-76	2 3/4 - 3	330	298	160	290	92	140	79	788	375	159	227
OSS 142 P	720	87-93	3 1/2 - 3 5/8	78-86	3 1/16 - 3 3/8	356	318	178	320	99	152	83	852	400	171	283
OSS 144 P	875	94-102	3 3/4 - 4	88-96	3 7/16 - 3 3/4	381	343	190	350	108	178	89	914	435	191	347
OSS 146 P	1200	108-115	4 1/4 - 4 1/2	98-110	3 7/8 - 4 5/16	450	480	215	400	129	195	100	1145	465	205	539
OSS 150 P	1400	120-130	4 3/4 - 5	112-124	4 7/16 - 4 7/8	500	500	250	450	147	220	110	1250	525	225	761
OSS 155 P	1600	135-140	5 1/4 - 5 1/2	125-132	4 15/16 - 5 3/16	540	497	263	480	157	240	140	1300	590	230	1067
OSS 160 P	2000	142-153	5 3/4 - 6	133-143	5 1/4 - 5 5/8	585	505	275	500	171	255	140	1365	610	250	1172
OSS 165 P	2220	154-165	6 1/4 - 6 1/2	144-154	5 11/16 - 6 1/4	630	530	300	550	185	257	150	1460	640	260	1441
OSS 170 P	2500	166-178	6 3/4 - 7	155-166	6 1/4 - 6 3/4	680	570	310	570	199	295	150	1560	660	280	1615
OSS 175 P	2800	180-191	7 1/4 - 7 1/2	167-179	6 9/16 - 7 1/16	725	600	325	600	213	310	155	1650	689	300	1907
OSS 180 P	3200	192-204	7 3/4 - 8	180-191	7 1/4 - 7 1/2	775	620	345	640	229	330	160	1740	720	320	2239

MBL = Minimum Breaking Load

The standard nish of our sockets is blue. Hot dipped galvanized is also available. Socket range OSS 196 until OSS 100 is delivered with galvanized nish, other nishes are available upon request.

All sockets are provided with an EN 10204-2.1 declaration of conformity, EN 10204-3.1 material certificate and can be provided with a 2006/42/EC declaration where applicable.

OPEN WEDGE SOCKETS

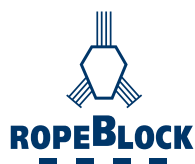

Open Wedge Sockets

Fast detachable socket range for wire rope diameter 7 - 86 mm (5/16" - 3 3/8").
Basket and wedge in quenched and tempered cast steel. Wedge and basket are designed for easy installation and optimal wire rope efficiency.

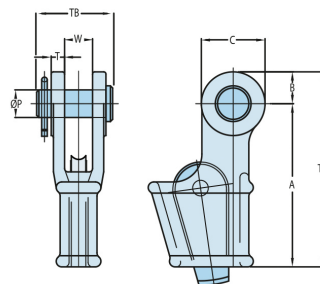

Model nr.	MBL (Mtons)	for wire Ø		Dimensions(mm)								Weight (kg)
		mm	inch	A	B	C	Ø P	T	TL	TB	W	
OWS 0.25 P	8	7-8	5/16	110	18	36	16	9	128	51	18	0,8
OWS 0.5 P	12	9-10	3/8	145	23	46	20,6	11	168	63	20,5	1,7
OWS 1 P	20	11-13	1/2	146	28,5	57	25	12	174,5	67	25	2,1
OWS 2 P	25	14-16	5/8	176	35	70	30	15	211	85	31	4
OWS 3 P	40	18-19	3/4	210	40	80	35	16	250	95	38	7
OWS 4 P	55	20-22	7/8	237,5	47,5	95	41	18	285	110	44	10
OWS 5 P	75	24-26	1	275	55	110	51	22	330	128	51	15
OWS 6 P	90	27-29	1 1/8	310	65	130	57	25	375	142	57	21
OWS 7 P	110	30-32	1 1/4	350	73	146	63	28	423	155	63	31
OWS 8 P	125	34-32	1 3/8	400	74	148	64	28	474	160	70	37
OWS 9 P	150	34-36	1 1/2	450	80	142	70	30	530	177	77	51
OWS 10 P	170	37-39	1 5/8	500	87	160	76	33	587	187	76	64
OWS 11 P	225	40-42	1 3/4 - 1 7/8	550	100	186	89	39	650	215	89	96
OWS 12 P	280	49-52	2	640	105	205	95	46	745	244	101	130
OWS 13 P	360	54-58	2 1/4	660	125	250	108	54	785	275	114	180
OWS 14 P	425	60-68	2 1/2	835	135	270	121	60	970	300	127	275
OWS 15	460	72-76	3	1000	150	300	133	76	1150	355	146	440
OWS 16 P	625	81-86	3 1/4 - 3 3/8	1100	150	300	140	79	1250	375	159	510

MBL = Minimum Breaking Load

The standard nish of our sockets is blue. Hot dipped galvanized is also available. Socket range OWS 0.25 until OWS 0.5 is delivered with galvanized nish, other nishes are available upon request. All sockets are provided with an EN 10204-2.1 declaration of conformity, EN 10204-3.1 material certificate and can be provided with a 2006/42/EC declaration where applicable. Meets performance requirements of API 2C.

CASTORS & WHEELS



BHS Series



BDS Series



GGSE Series



GHKE Series



GRDE Series



GRDDE Series



SAB Series



ABLP Series



DABLP Series



DABE50 Series



GGSE-SPR Series



GHKE-SS Series





HYDRAULIC EQUIPMENT

Hi-Force
HYDRAULIC TOOLS



5T



10T



25T

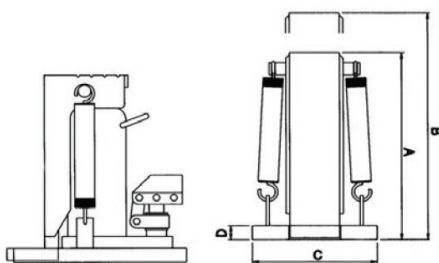

Capacity (Tonne)	Lifting of Foot (mm)	Lifting of Head (mm)	Lowest of Foot / Head (mm)
5	230	575	25/368
10	260	650	30/420
25	275	720	58/500

SKATES SETS



Skates Sets

- Polyurethane wheels to prevent damage to flooring.
- Steering skates have 'easy spin' ball bearing turntables.
- Solid heavy duty Construction.
- Replaceable spare parts.
- Easy to Steer.



Product Code	Capacity in tonnes	Steering Skate Length (mm)	Steering Skate Width (mm)	Trailing Skate Length (mm)	Trailing Skate Width (mm)	Height (mm) All Skates
SKT8TS 4tonne steering 2 x2tonne trailing	8	240	210	170	130	110
SKT16TS 8tonne steering 2 x4tonne trailing	16	500	645	200	200	110
SKT24TS 12tonne steering 2 x6tonne trailing	24	530	750	200	220	110
SKT32TS 16tonne steering 2 x8tonne trailing	32	530	920	250	310	110
SKT36TS 18tonne steering 2 x9tonne trailing	38	610	750	310	240	110

MAN BASKET

As Per International Standard



HEIGHT SAFETY EQUIPMENT



P-10 Safety Harness

Ref. AB 110 01
EN 361



P-30 Safety Harness

Ref. AB 130 01
EN 361

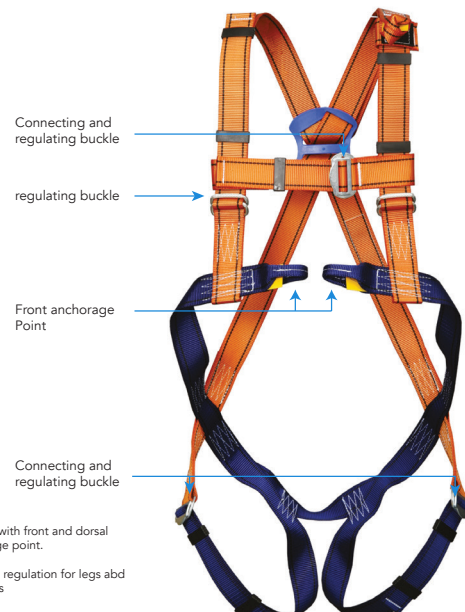

Model P-10 Safety Harness



- Full safety harness.
- Comfortable to wear.
- Rear "D" attachment.
- Double adjustment (leg & chest).
- Easy to fit.
- Extremely light / comfortable
- Available in sizes M / XL / XXL
- Complies to BS EN 361:2002

Model P-30 Safety Harness



- Full safety harness.
- Comfortable to wear.
- Front & Rear "D" attachment.
- Double adjustment (leg & chest).
- Easy to fit.
- Extremely light / comfortable
- Available in sizes M / XL / XXL
- Complies to BS EN 361:2002

Model P-50 Safety Harness



- Full safety harness.
- Comfortable to wear.
- Front & Rear attachment.
- Front attachment for rescue
- Double adjustment (leg & chest).
- Easy to fit.
- Extremely light / comfortable
- Available in sizes M / XL / XXL
- Complies to BS EN 361:2002

HEIGHT SAFETY EQUIPMENT



Shock Absorbing Lanyards

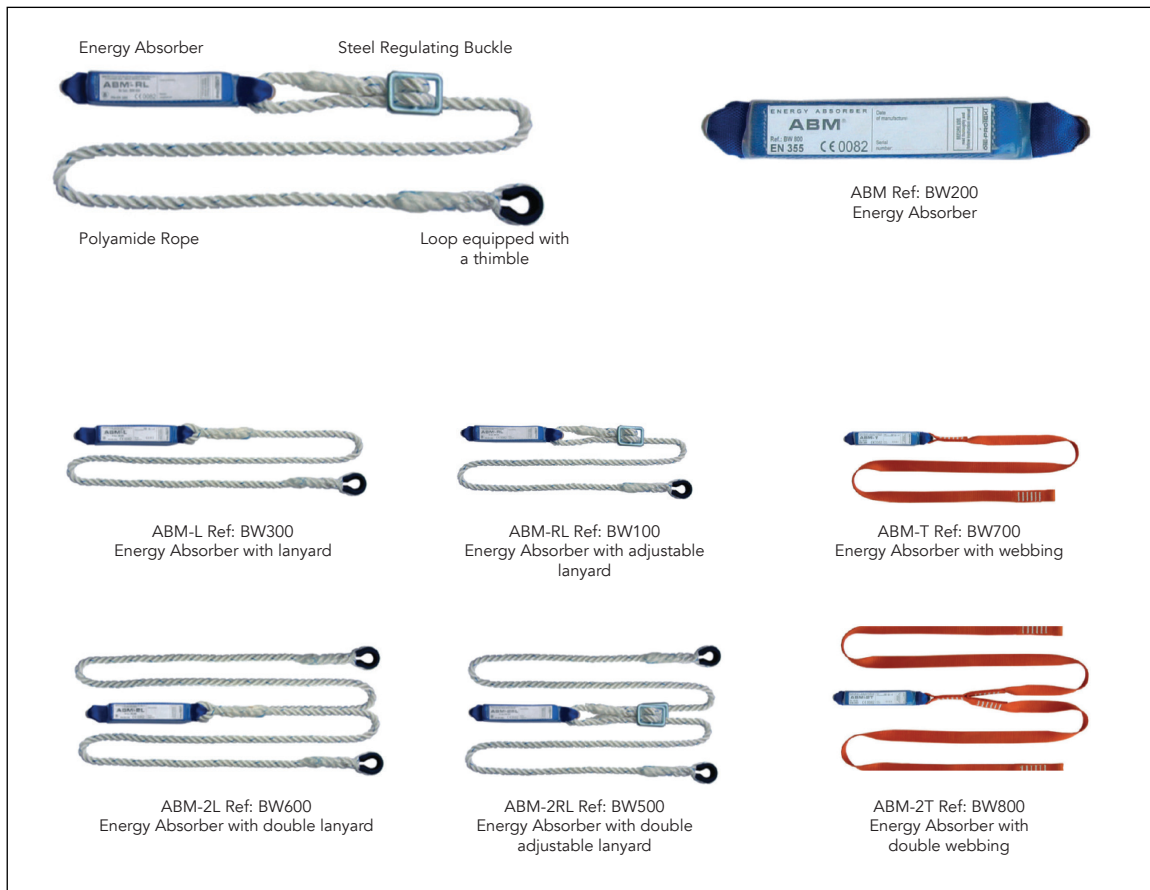
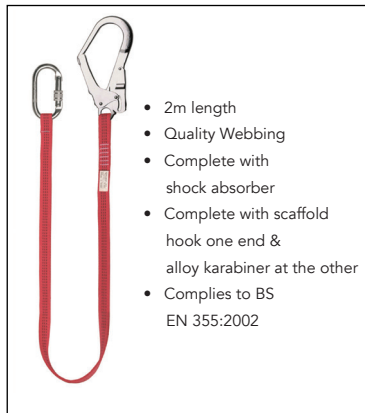

HEIGHT SAFETY EQUIPMENT

Tripod & Winch



- Aluminium construction for ease of lifting
- 2.14 meters fully extended, 1.34 meters fully retracted
- Telescopic legs
- Secondary safety anchorage
- Supplied with security chain around base
- Stabilizing feet with rubber grips
- Easy to erect
- Winch has 20 meters of galvanized cable
- Automatic brake
- Easy attachment of winch to tripod
- Both items comply to EN standards



**Tripod complies with standard
BS EN 795 CLASS B: 1997**
**Winch complies with standard
BS EN 1496 CLASS B: 1996**

P10R Rescue Harness



- Easy to fit rescue harness
- Complete with front & rear fall arrest points
- Loop for attachment of rescue equipment
- Double adjustment for comfort
- Complies to current registration
- Size M – XL

Vertical Safety Lines



- Easy to use
 - Strong & reliable
- Ropes lengths available to suit your needs

MODEL

AC 010 Vertical rope grab with shock absorber
AC 102 20 Meter rope, 14mm diameter
AC 102 30 Meter rope, 14mm diameter



HEIGHT SAFETY EQUIPMENT



TM 12 Spider

Multi-Purpose Lifting Device



Use as a full set

or as a tripod

- Lifting & lowering of a person and/or equipment up to 1 tonne.
- Designed for use in confined space areas.
- Lightweight & portable as the TM12 breaks down into 3 key components.
- Flexibility, functions as a gantry when used as a whole assembly, or just the tripod assembly can be used for confined space lifting or lowering of people or equipment.
- Fully adjustable in both length & height.
- Extra gripping thorns on tripod feet for improved traction on slippery surfaces.
- Safety locking pins to prevent movement of a Beam Trolley.



HIGH PERFORMANCE STEEL WIRE ROPES

Introduction

verope 
rely on

The concept of Verope AG is to provide affordable high quality special wire ropes for crane applications to the world market. The new catalogue contains a well selected range of products, which have been approved by leading crane manufacturers. The products are available at our distributors in 25 countries in different continents.

We at Verope AG are pleased and proud to have satisfied our clients' needs worldwide and will continue in our uncompromising mission of high service standards, combined with quality products that you can rely on. Your requirement is our focus.

Pierre Verreet

Advantages of Verope

- Excellent strength to weight ratio
- Long fatigue life
- Good abrasion and wear resistance
- Good non-rotation properties
- Easy rope handling
- Excellent corrosion resistance
- Reliable quality assurance

VeroTop

Rotation-resistant rope, suitable as hoist rope for mobile cranes, tower cranes, crawler cranes, piledriving equipments.

VeroTop P

Rotation resistant rope, suitable as hoist rope especially for cranes working in marine environment such as desk cranes, offshore cranes.

VeroStar 8

8-strand non rotation resistant rope suitable as hoist ropes for multiple part reeving systems with right – and left hand layed ropes working as a pair such as container cranes, steel mill cranes, overhead travelling cranes.

VeroPro 8

8-strand non rotation resistant hoist rope with compacted outer strands for container handling cranes, steel mill cranes, mobile harbor cranes, overhead travelling cranes, boom hoist application.

VeroPower 6

6-strand non rotation resistant rope with compacted and rotary swaged strands. Suitable as hoist rope for cranes with guided loads working in multiple layer on the drum, such as boom hoist ropes for mobile cranes, crawler cranes, grap applications etc. can also be used as hoist rope for container handling cranes, overhead travelling cranes.

VeroPower 8

8-strand non rotation resistant rope with compacted and rotary swaged strands. Suitable as hoist rope for container cranes, steel mill cranes, boom hoist applications, etc. Very high breaking strength and most suitable for multi-layer spooling devices.



HIGH PERFORMANCE STEEL WIRE ROPES



Introduction

Originally founded in Taiwan in 1987, Britx Wire Rope Ind. Corp. is a well-known wire rope manufacturer focusing on high quality products in various fields including industrial ropes, control cables for automobile industry, elevator ropes, etc.

Currently more than 60% of products are for the overseas market. The company is built up with significant experience in rope production and management system by integrating both Taiwan and China's excellences.

"Perfect Quality" is a BRITX's goal in which we have provided the best quality with achievements in quality management systems including
ISO 9001:2008, JIS G 3525:2006
ISO/IEC17025:2005, ISO/TS16949:2002

BRITX will continue to work hard and sincerely with its excellent quality and service to fulfill the commitment to our global customers for years to come.

The different wire rope constructions we offer are

- Steel Wire Rope Rotating 6 x 19
- Steel Wire Rope Rotating 6 x 36
- Steel Wire Rope Non Rotating 19 x 7
- Steel Wire Rope Fibre Core 6 x 24
- Stainless Steel Wire Rope 7 x 19
- PVC Coated Wire Rope 7 x 19

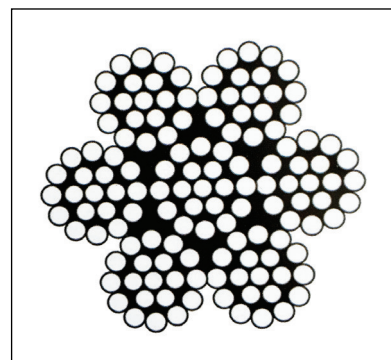
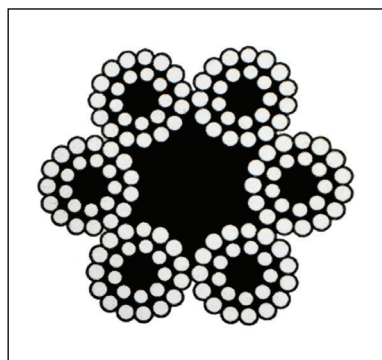
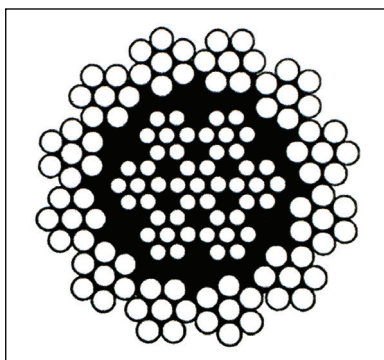

LOAD MONITORING EQUIPMENT

Introduction

Since 1976, Straightpoint have been the world leaders in the design and manufacture of a huge range of force measurement, load cell dynamometers for load monitoring and crane scales for suspended weighing load cells up to 1000t / 2.2 million lbs. capacity.

Straightpoint is the international standard for lifting projects; supplying load link load cells, dynamometers, load shackles, provided cabled or wireless (telemetry), crane scales, center of gravity and data logging systems.

In an industry where safety and quality are paramount, Straightpoint designs and manufactures to the highest standards, builds measurement equipment with world-class technical expertise and can deliver solutions quickly from its many locations around the world.

Straightpoint products offer load monitoring, weighing and force measurement solutions, and can be found in oil and gas, shipping, construction, renewable energies, lifting and cranes, mining, staging, test and inspection, and military applications.

- Loadlink Plus
- Radiolink Plus
- Compound Plus
- Wireless Shackle Loadcells
- Wireless Centre of Gravity System
- Wireless Accessories
- Wirelink Plus
- Shackle Loadcells
- Load Pins
- Minoweigher Plus
- Jumboweigher
- 'S' Beam Loadcells
- Loadblock Plus
- Compression Loadcells



STEELWORK CLAMPING SYSTEMS

Introduction



For more than 80 years, Lindapter has earned a respected reputation as the inventor and pioneer of steelwork clamping systems, providing an independently approved and exclusive product range of

- Steelwork Fixings
- Cavity Fixings
- Decking Fixings
- Support Fixings
- Floor Fixings
- Rail Fixings

Whether joining primary structural sections, securing secondary beams or suspending building services, Lindapter has a proven, accredited solution.

Lindapter has manufactured to the highest standard for three quarters of a century, earning a multitude of independent approvals and a reputation synonymous with safety and reliability. Current accreditations awarded by international associations include Lloyds Register, TÜV NORD, Deutsches Institut für Bautechnik and Det Norske Veritas.

Lindapter is specified on countless projects across the globe from the Antarctic to the Caribbean, in diverse applications as varied as the London Tower Bridge, Target Field Ballpark, Dubai Shopping Mall and Gautrain Rapid Rail Link.

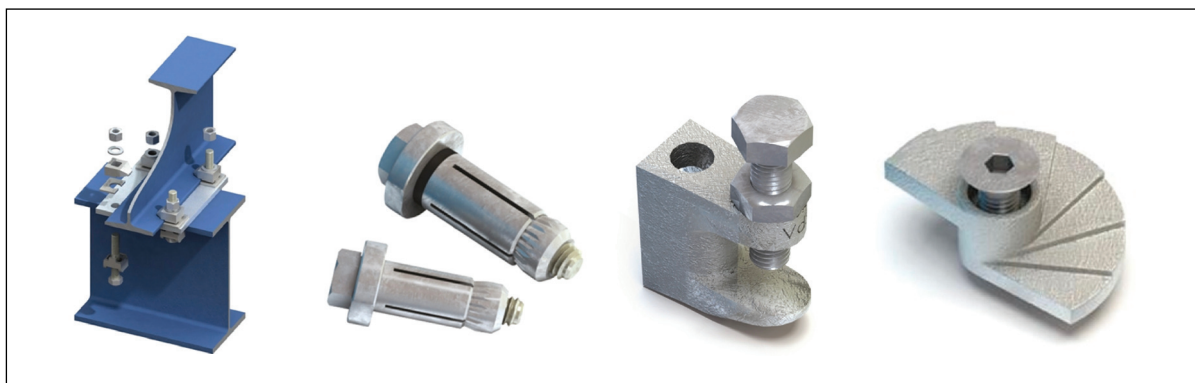

Lindapter is a member of the following organisations:



GRIFFIN-WOODHOUSE LTD

A trusted partner that delivers competitively priced, quality assured mooring systems for floating offshore projects world-wide.



INTRODUCTION

Total Mooring Solutions

Established in 1790, Griffin-Woodhouse Limited has a distinguished history and is globally acknowledged as a leader in the design, manufacture and supply of 'Offshore Mooring Equipment'.

Exporting world-wide, GWEC engineers systems to 'Exceed Client Expectations'. Our ability to deliver 'Total Mooring Solutions' is based on extensive knowledge and experience acquired over hundreds of years.

Our equipment can be employed to secure any floating structure, also during towing and installation activities.

Typical offshore oil & gas applications include Floating Production Storage & Offloading (FPSO/ FSO), Subsea Umbilicals, Risers & Flowlines (SURF), Mobile Offshore

Drilling Units (MODU), Anchor Handling Vessels (AHV), Single Point Mooring (SPM), Conventional/ Multi-Buoy Mooring (CBM/ MBM).



OUR STORY

The birth of British chain manufacturing followed registration of the first chain patent by Philip White in 1634 and there is evidence the Timmington, Griffin and Woodhouse families have been involved in chain making since the 18th century.

In 1988 Griffin-Woodhouse Limited was acquired exclusively by the Timmington family who continue as custodians of the business today. Our head office in Cradley Heath is at the heart of the 'Black Country', an area to the west of Birmingham synonymous with the Industrial Revolution around 1760.



GRIFFIN-WOODHOUSE LTD

A trusted partner that delivers competitively priced, quality assured mooring systems for floating offshore projects world-wide.



PROUD HISTORY

Griffin-Woodhouse has always been located in the heart of the 'Black Country', an area to the west of Birmingham synonymous with the birth of the Industrial Revolution in Britain around 1760. The region today comprises four Metropolitan District Council areas including Sandwell, in which Cradley Heath is located.

The Black Country gained its name in the mid-nineteenth century due to the smoke from many thousands of ironworking foundries, forges and the abundance of coal in shallow, 30ft. thick seams.



The region's flag features a chain to represent its manufacturing heritage whilst the white shape in the background recalls the iconic glass cones and iron furnaces that featured in the architectural landscape. The red and black colours recall the famous description

of the Black Country by Elihu Burrit, American Consul to Birmingham in 1862, that it was "black by day and red by night" owing to the smoke and fires of industry.

Other authors, from Charles Dickens to William Shenstone refer to the intensity of manufacturing in the Black Country and its effect on the landscape and its people.



QUALITY ASSURED PRODUCTS

Established in 1790, Griffin-Woodhouse has a distinguished history and is globally acknowledged as a leader in design, manufacture and supply of offshore mooring equipment. We work closely with clients and offer a technical advisory service as standard under our contract review process.

Our quality policy includes a commitment to exceed expectations through a culture of quality, by building strong relationships, being responsive to customer needs and communicating effectively.

The implementation of ISO 9001:2015 is strategic decision based on business mar

agement, process improvement and client reassurance. However, the company has maintained a robust quality system since the early 1950s.



HARBOUR EQUIPMENT & MACHINERY

Introduction



Prosertek is one of the leading companies in the global maritime equipment market for ship docking, with over 20 years of experience in the sector, with a wide range of products served all over the world.

Our main areas of business and activity are:

- Ship docking fenders.
- Quick release hooks.
- Berthing Aid Systems.
- Telescopic ship access gangways.
- Bollards.

Our staff is highly motivated, qualified and undergo ongoing training, whilst our in-house research, control and testing departments offer a rapid and effective service.

We design, manufacture, test, transport, install and provide after sales technical assistance with our own resources, thus allowing our customers to receive a complete service without any third party dependency.

Docking Fenders



Quick Release Hooks



Berthing Aid Systems



Marine Gangways



Bollards



OUR PARTNERS

Hi-Force
HYDRAULIC TOOLS

BRIDON · BEKAERT
THE ROPES GROUP

verope 
rely on

PORTAFLOOR®

 **straightpoint**
making the lifting industry a safer place

 **FORCE**
SAFETY AT HEIGHT PRODUCTS

lindapter®

Severstal 

LIFTING  **GEAR.UK**

GWEC™

'Mooring for the World'

 **prosertek**
HARBOUR EQUIPMENT

 **MUYTONS**
Complete Castor + Wheel Solutions

CMS
COLUMBUS MCKINNON

MOLYSLIP®

TESTING DEPARTMENT



Our inspection and testing division (Al Nasr Technical Trading Agencies – Equipments Technical Inspection) can provide both in-house and site inspection and testing of lifting equipment and accessories. We are accredited by Dubai Accreditation Department (DAC) in accordance with the requirements of **ISO/IEC 17020:2012**, to undertake inspection in the field of lifting equipment and accessories. We are also approved by Abu Dhabi Municipality to provide our service in the Emirate of Abu Dhabi.

ANETI has developed, implemented and maintained the integrated QHSE Management system in accordance with the requirements of international standards ISO 9001:2015, ISO 14001:2015 and ISO 45001:2018.

We have competent inspection engineers who can visit your site to provide our services or alternatively, you can send your equipment to our inspection and testing facility.

At our facility, we have a horizontal test bed (100 T capacity) and a vertical test bed (300 T capacity) to carry out testing of various types of lifting equipment and accessories. In particular, we can carry out load testing of spreader/ lifting beams on our 300 T vertical test bed.

Upon completion of the testing, we shall provide final reports, including the graph of the test that has been carried out.



- Load testing and certification of fork lift.
- Visual inspection and certification of loose lifting gears such as shackles, wire rope sling, chain slings etc..
- Load testing and certification of all fabricated structure as per client's requirements.
- Break testing of wire rope slings, shackles, chain sling in our hydraulic testing machine up to 300 TON
- We do proof load testing of spreader beams, hook blocks, slings etc.. to validate the overall integrity of item in our horizontal hydraulic test bed machines.

Value-added services

We repair, service and refurbish a vast range of lifting equipment including chain slings, plate clamps, lever hoist, chain block and we are giving load cells with shackles, spreader beams, modulift beams in a rental basis.

Scope of EIAC accreditation

- 1.LIFTING ACCESSORIES:** Periodic and thorough examination of Shackle, eye bolt, round sling, webbing sling, spreader beam, plate clamp, beam clamp, wire rope sling, chain sling.
- 2.LIFTING EQUIPMENTS:** Periodic and thorough examination of Forklift, hand powered trolley supporting lifting machine, chain block, hoist, jaw winch.

CNC MACHINING • STEEL FABRICATION • REPAIR & MAINTENANCE • SPECIALIZED PRECISION SERVICES

At Alnasr Metal Industries, we conduct a wide range of welding and fabrications projects for the Oil & Gas and Construction industries. Our specialized products and services consist of the fabrication of containers, different types of onshore and offshore baskets, mud skips designed specifically for the Oilfield sector, lifting beams, lifting frames, waste skips, refurbishment and testing of used cargo carrying units, etc.

We have a line of qualified welders certified by third party agencies and all of our fabricated products are subject to third party Proof Load tests along with Magnetic Particle Inspection (MPI), which are all carried out at our facility.

AMI FABRICATION SERVICES Our specialities include:

BASKETS & CARGO CARRYING UNITS (CCUS)

*Cargo Baskets (onshore /offshore)
(DNV2.7-1 / BSEN 12079 and customer's specs)*

1. Chemical / Drum Basket
2. Man Basket
3. Small & Long Cargo Basket
4. Steel Cage, Wire Line Basket

*Cargo Carrying Units
(DNV2.7-1 / BSEN 12079 and customer's specs)*

1. Tool Rack Basket
2. Tool Box
3. Skids
4. Lifting Frames for Compressors and Generators
5. Radiation Active Box or Other Special Tools

** The units are supplied with certified slings and shackles as standard "if required"*



FORKLIFT ATTACHMENTS



1. Lifting Attachment
2. Extension Attachment
3. Man Basket

** Custom Design and Fabrication as per customer specifications, supplied with required test and certification by approved third parties.*

RACKS



1. Sling Storage Stand,
2. Pipe Rack Stand,
3. Container Storage Rack
4. Tool Rack,
5. Treating & Auxiliary Iron Rack

** Custom Design and Fabrication as per customer specifications, supplied with required test and certification by approved third parties.*

SKIP BASKET



1. Waste Skip Baskets
2. Cutting Box

** Custom Design and Fabrication as per customer specifications, supplied with required test and certification by approved third parties.*

SPREADER BEAMS & LIFTING BEAMS

1. Two Point Lift with a Central Suspension
2. Two Point Lift with a 2-leg Suspension for More Stability (also can add with a wider chain sling spread)
3. Four Point Lift with a 2-leg Suspension
4. Custom Design as per Application

** Custom Design and Fabrication as per customer specifications, supplied with required test and certification by approved third parties.*



CNC MACHINING • STEEL FABRICATION • REPAIR & MAINTENANCE • SPECIALIZED PRECISION SERVICES

STORAGE CONTAINER, TOOL ROOM CONTAINER, OFFSHORE CONTAINER



1. Fabrication
2. Modification
3. Repair
4. Re-certification and Load Test by TPI



FABRICATION AS PER CUSTOMER DESIGN AND DRAWING

High Pressure Pipe Line Fabrication
& Welding based on customer design
and drawing
Saw Welding (automatic)



Structural Steel Sheds & Industrial
Steel Ladders, Staircases, Working
Platforms based on customer design
and drawing



Water and Fuel Tanks –
Cylindrical / Vertical
Steel Truss Space Frame for Station
Miscellaneous Steel Works



Single, Cantilever & Pergola Car
Parking Shed, Canopy, Tensile Fabric
Shade Structures



Repairing / Refurbishment &
Recertification - Oil Field Services
DNV Load Test / MPI & Certification

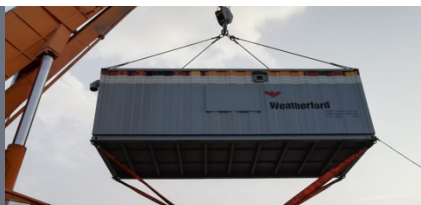



CSR

CORPORATE SOCIAL RESPONSIBILITY



Young ADIPEC, the annual youth outreach and engagement programme by the Abu Dhabi International Petroleum Exhibition and Conference (ADIPEC), held under the patronage of His Excellency Sheikh Nahayan Mubarak Al Nahayan, Minister of Tolerance and fully supported by Abu Dhabi Department of Education and Knowledge (ADEK).

Since its creation in 2013, the Young ADIPEC programme has received praise and recognition from across the oil and gas industry. Aimed at high school students aged between 14 – 17 years old, Young ADIPEC is designed to win the hearts and minds of today's youth and highlight the wealth and diversity of career opportunities in the oil and gas sector. Over 2,500 students from across the UAE have passed through the programme since its inception in 2013.



YOUNG ADIPEC 2018



YOUNG ADIPEC 2019



OUR CLIENTS





النصر للوكالات التجارية الفنية ذ.م.م.
ALNASR TECHNICAL TRADING AGENCIES L.L.C.

ABU DHABI

M43, Musaffah
P.O. Box 7355,
Abu Dhabi, U.A.E.
Tel: +971 2 551 2123
Fax: +971 2 551 2124
sales@atta.ae
www.atta.ae

SHARJAH

Industrial Area 2
P.O. Box 33298,
Sharjah, U.A.E.
Tel: +971 6 533 6567
Fax: +971 6 533 6532
sales@atta.ae
www.atta.ae

OMAN

Gulf Dhahi Trading
PO Box: 1761
Postal Code: 311
North Al Batinah Governorate
Sohar, Sultanate of Oman
sales@gulfdhabi.com
www.gulfdhabi.com

For all testing and certification queries testing@atta.ae